

CORTE 1

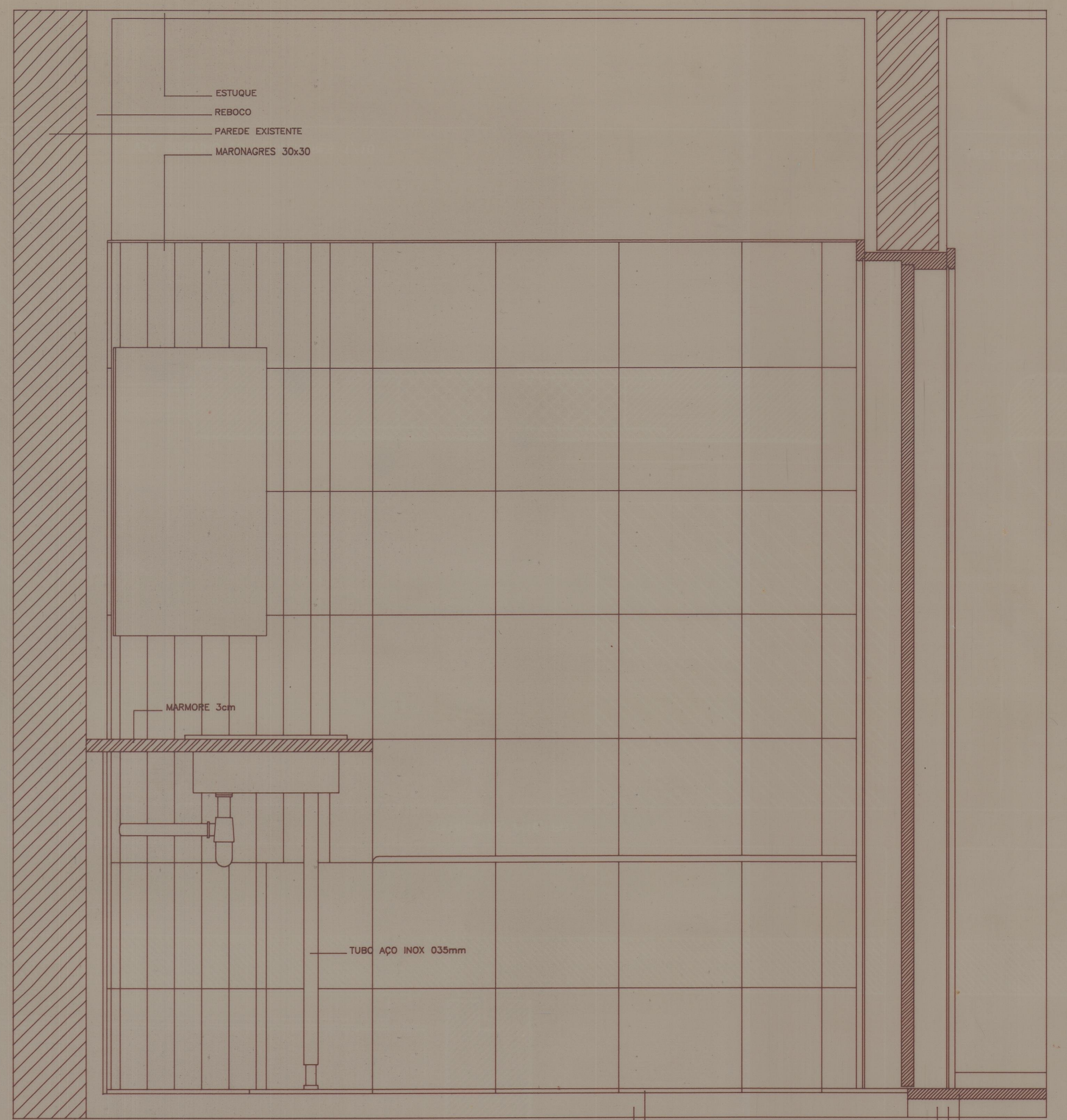

CORTE 2

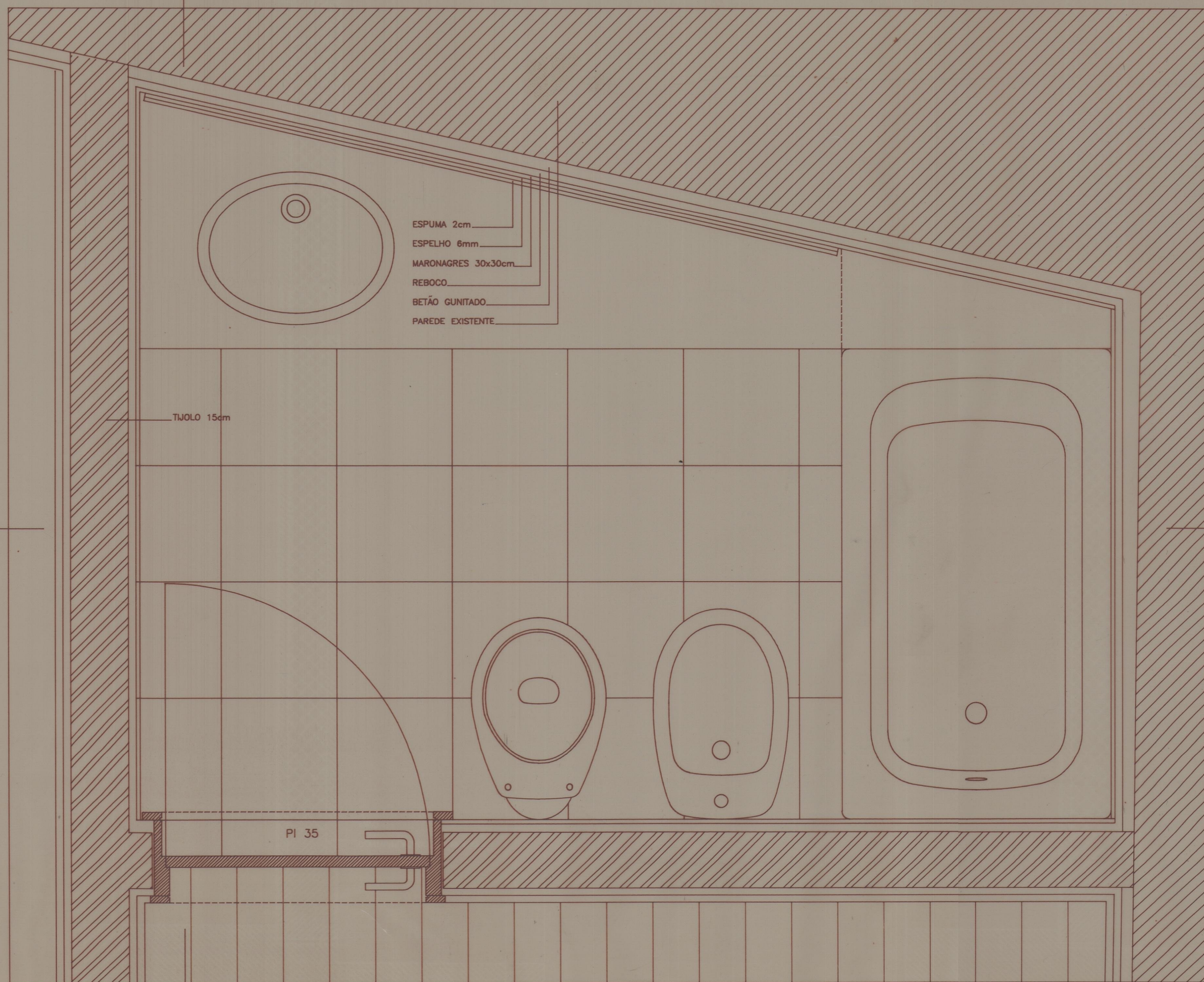

PLANTA

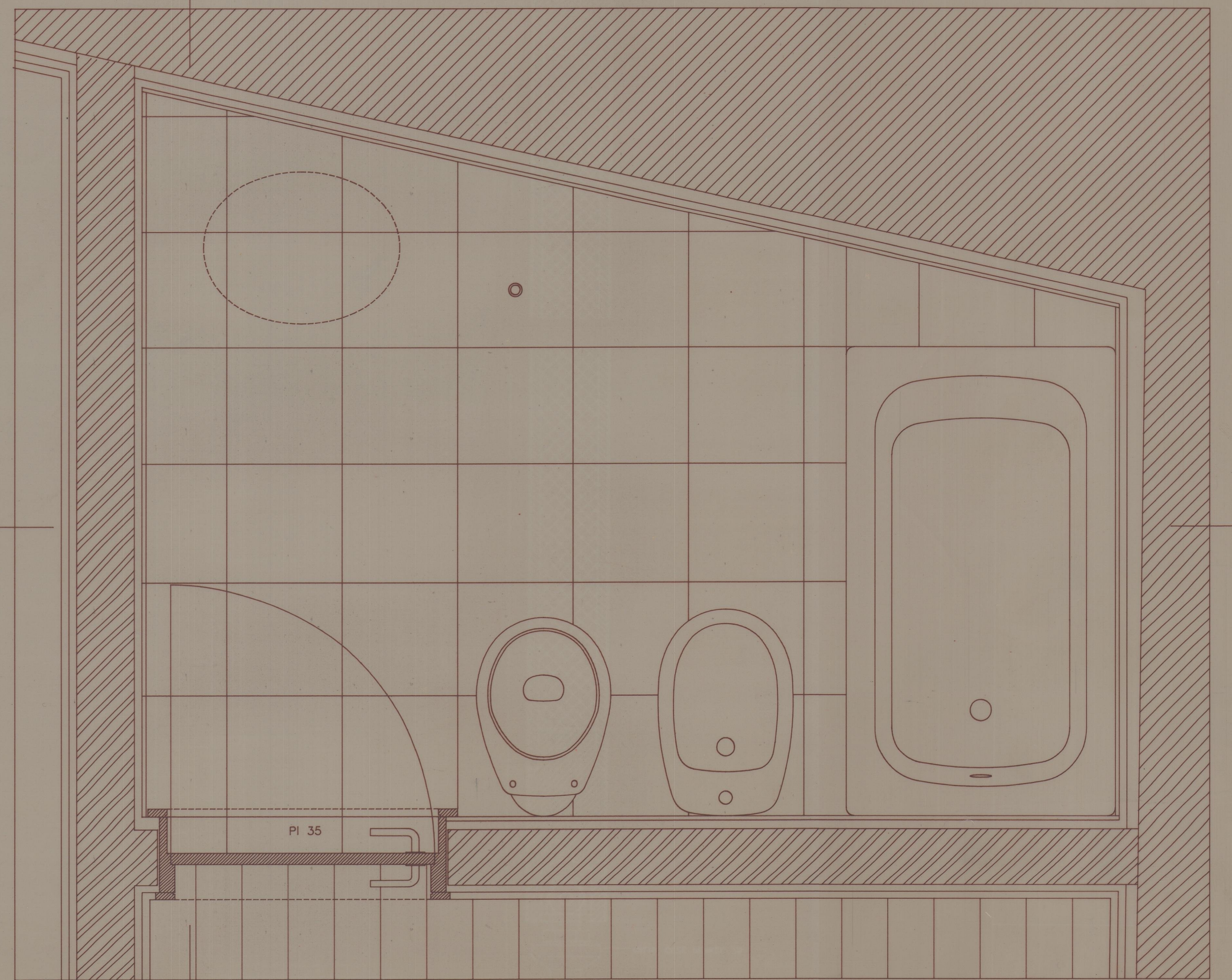

PLANTA

41-3377
Cota 2892

MUSEU DO ABADE DE BAÇAL - BRAGANÇA	Data	5/92	28
PROJECTO DE EXECUÇÃO - 1 FASE	Esc.	1/10	
FORMENOR 8 - PLANTAS, CORTES	Proj.	<i>Manuel M. Reis</i>	Arq. MAB_PORB-10 92.12
ANTÓNIO PORTUGAL, arquitecto - MANUEL M REIS		R CONSTITUIÇÃO 762 1E 4200 PORTO Tel(02)+100058 Fax(02)+106894	