

MC

MINISTÉRIO DA CULTURA



ippar

Instituto Português do
Património Arquitectónico

INSTITUTO PORTUGUÊS DO PATRIMÓNIO ARQUITECTÓNICO

Mosteiro de Santa Clara-a-Velha de Coimbra

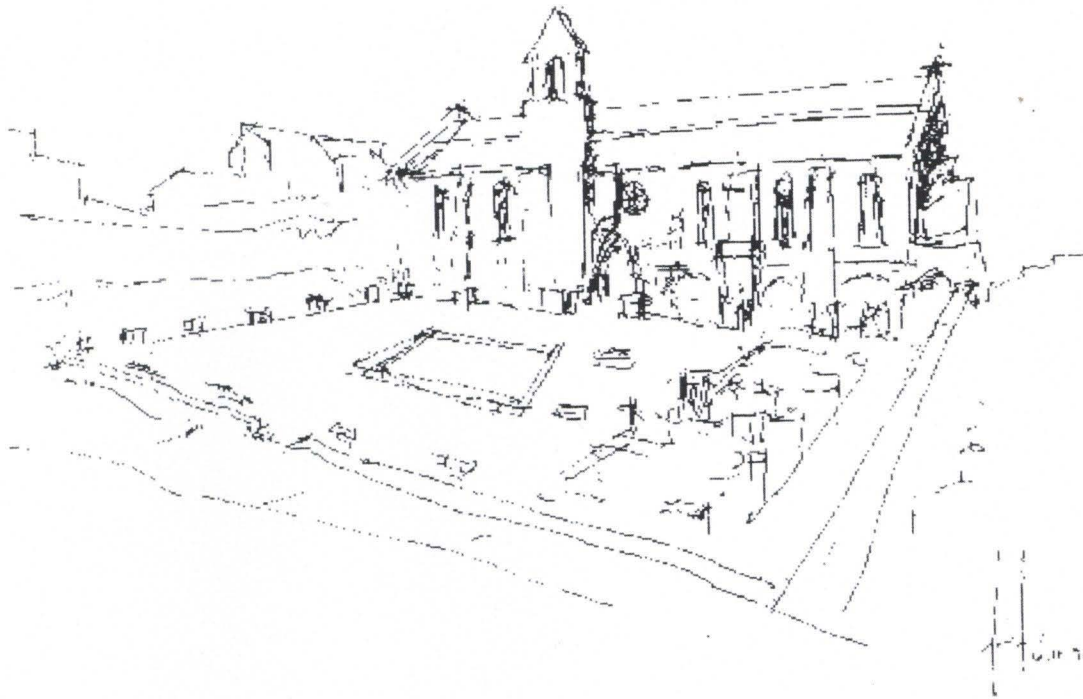

Gabinete de Desenho

ASSUNTO: Zona do Passadigo

DATA:/...../.....

PONTO DE SITUAÇÃO:.....

Zona das colinas P/ Alto do
masteiro.

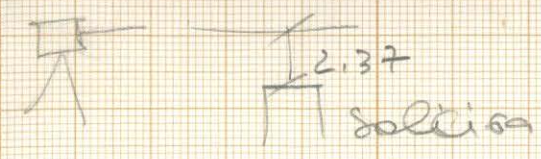

Soleira 2.37

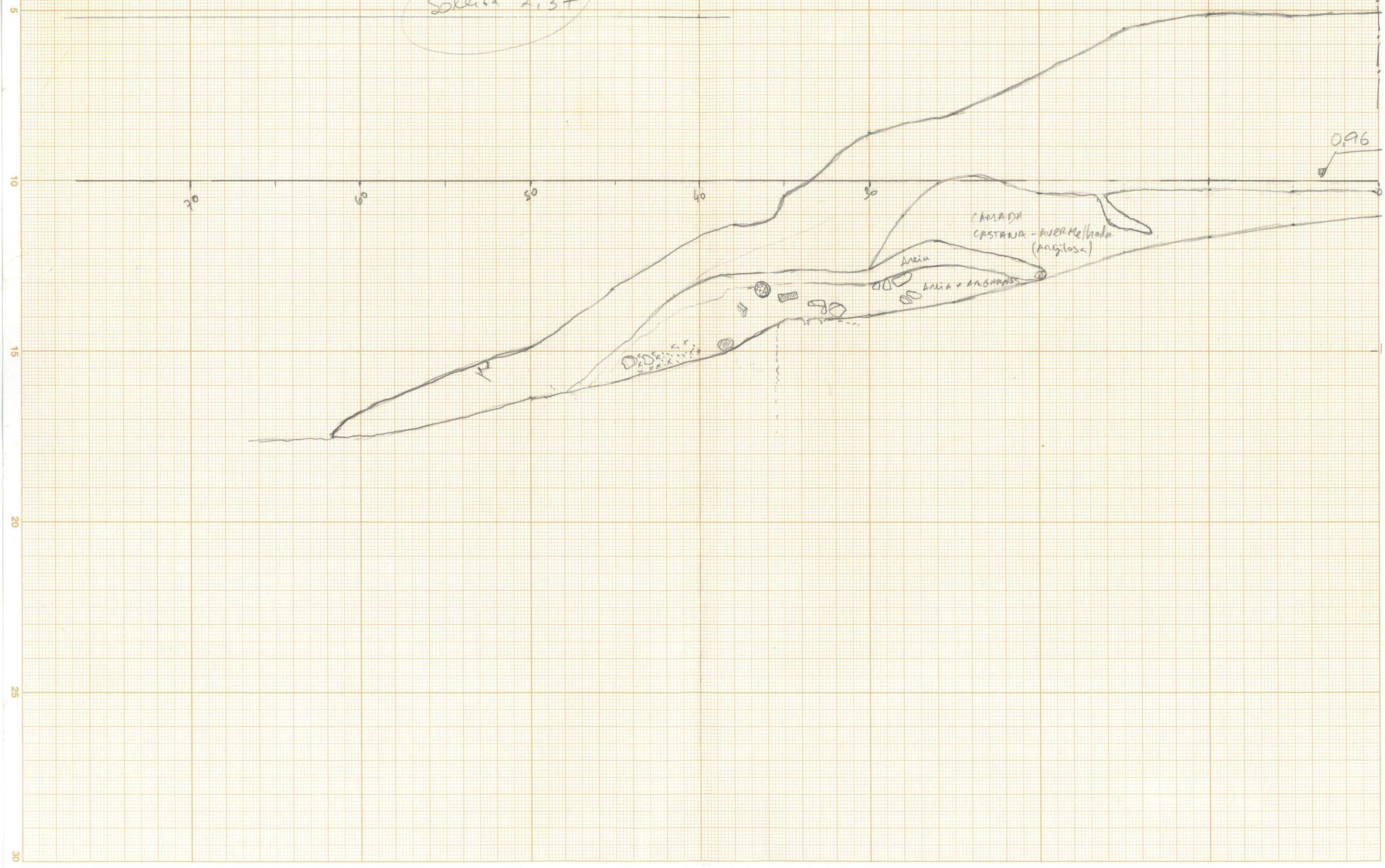

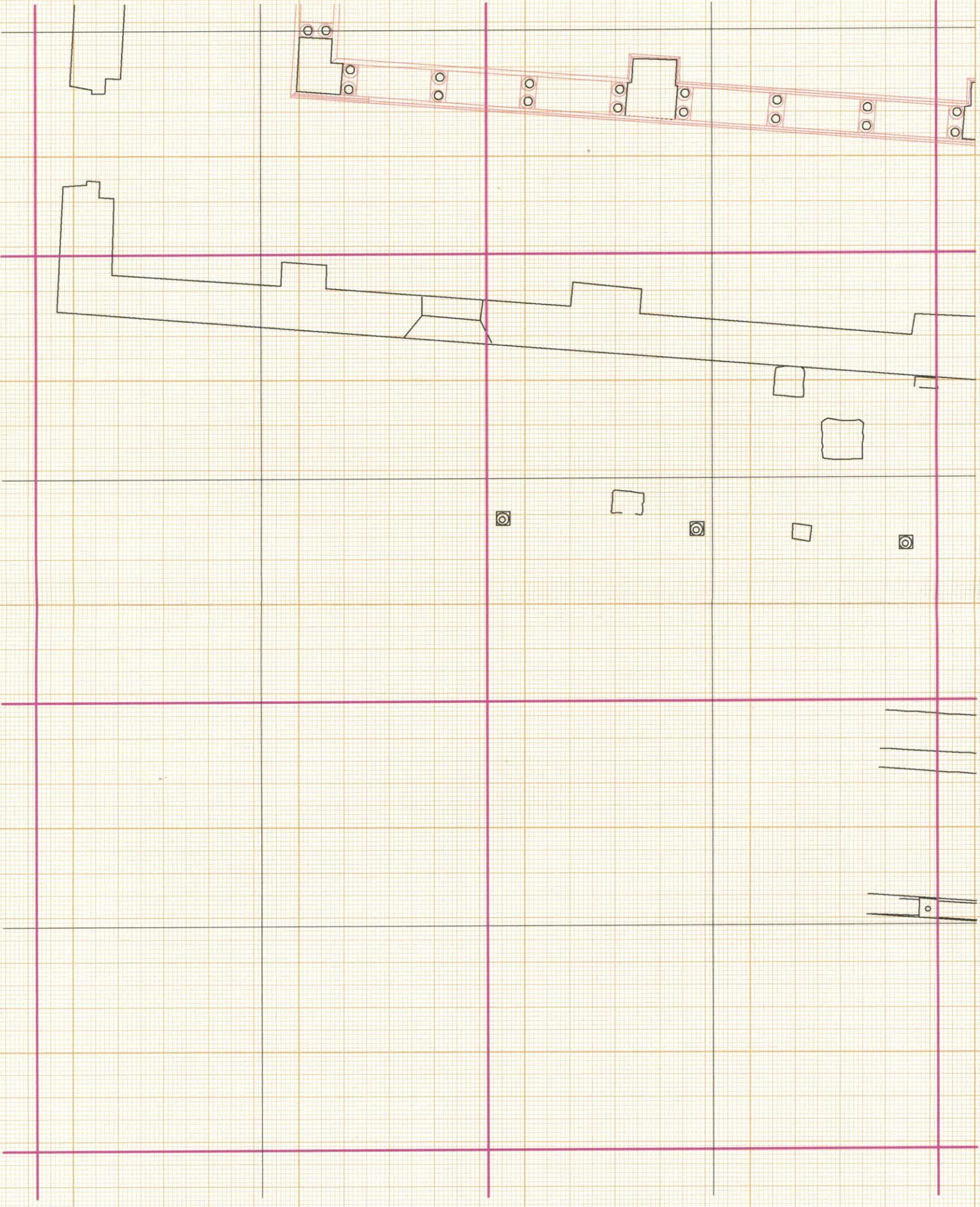

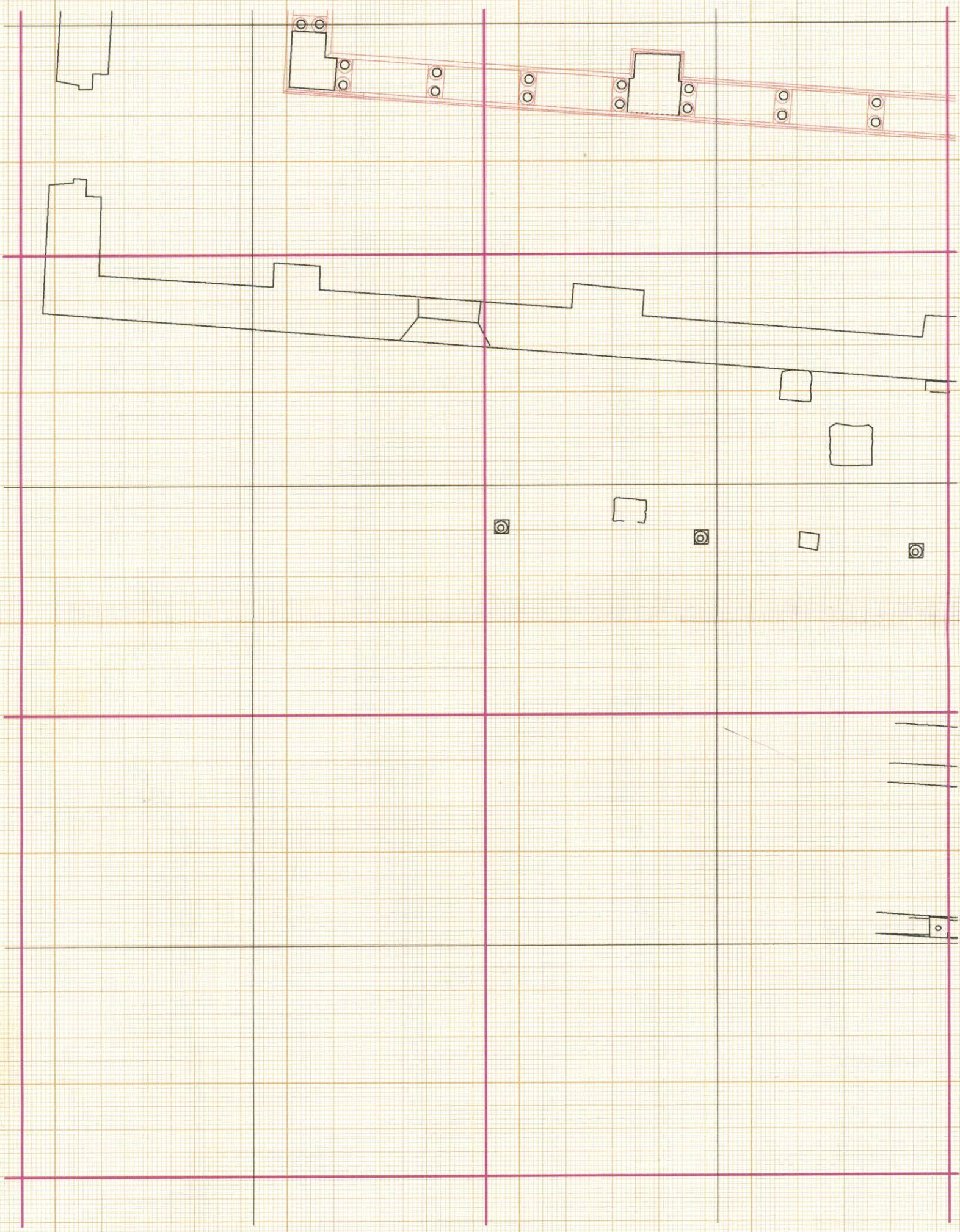

Technical drawing details including:

- Three vertical lines on the right side.
- A horizontal line below the vertical lines.
- A small square symbol with a dot inside, located below the horizontal line.

2
1
3
5
7
11
13

3.52
294
357
m't
1/20
m's
86

