

SONDAGEM N= 32

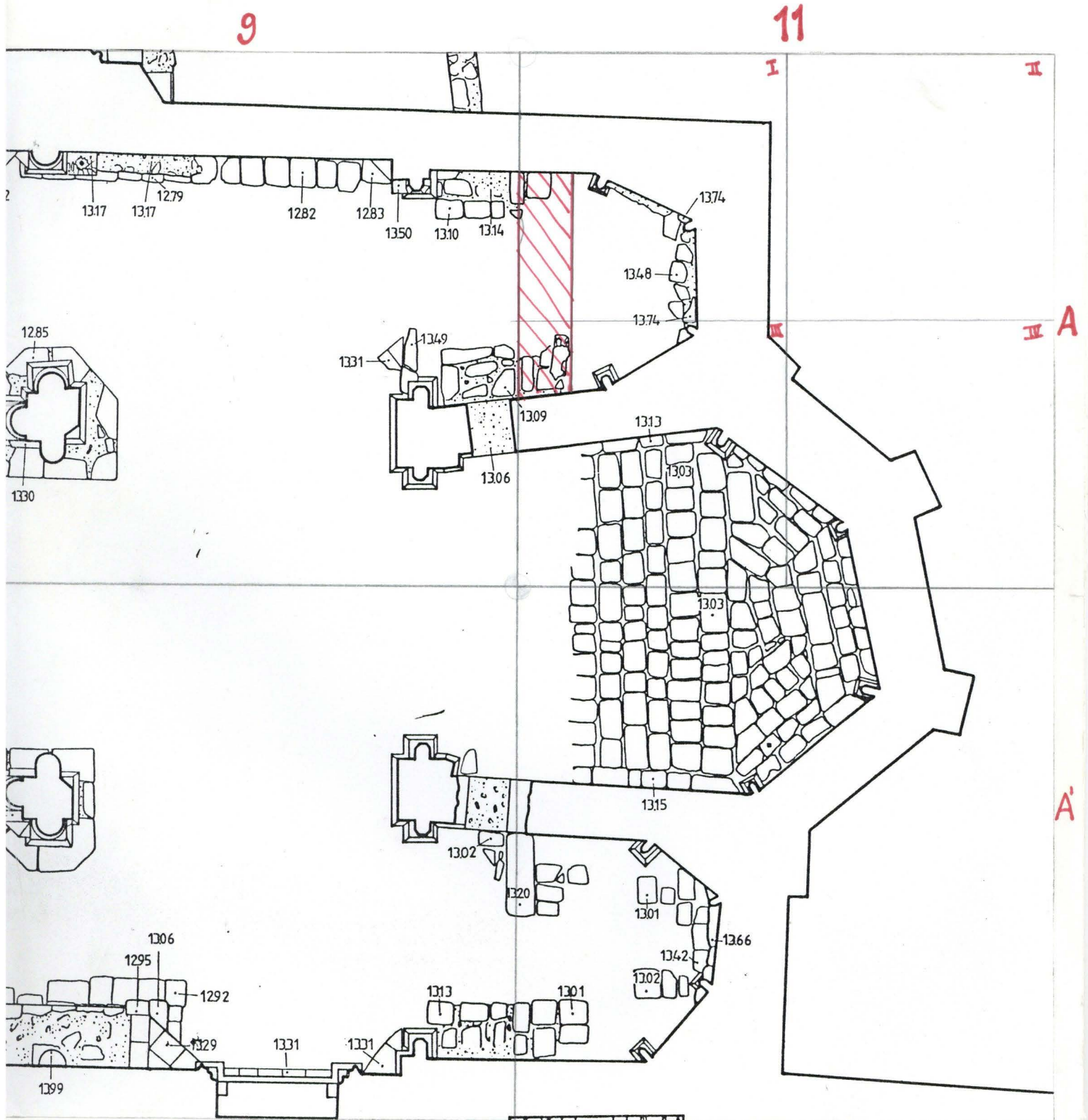

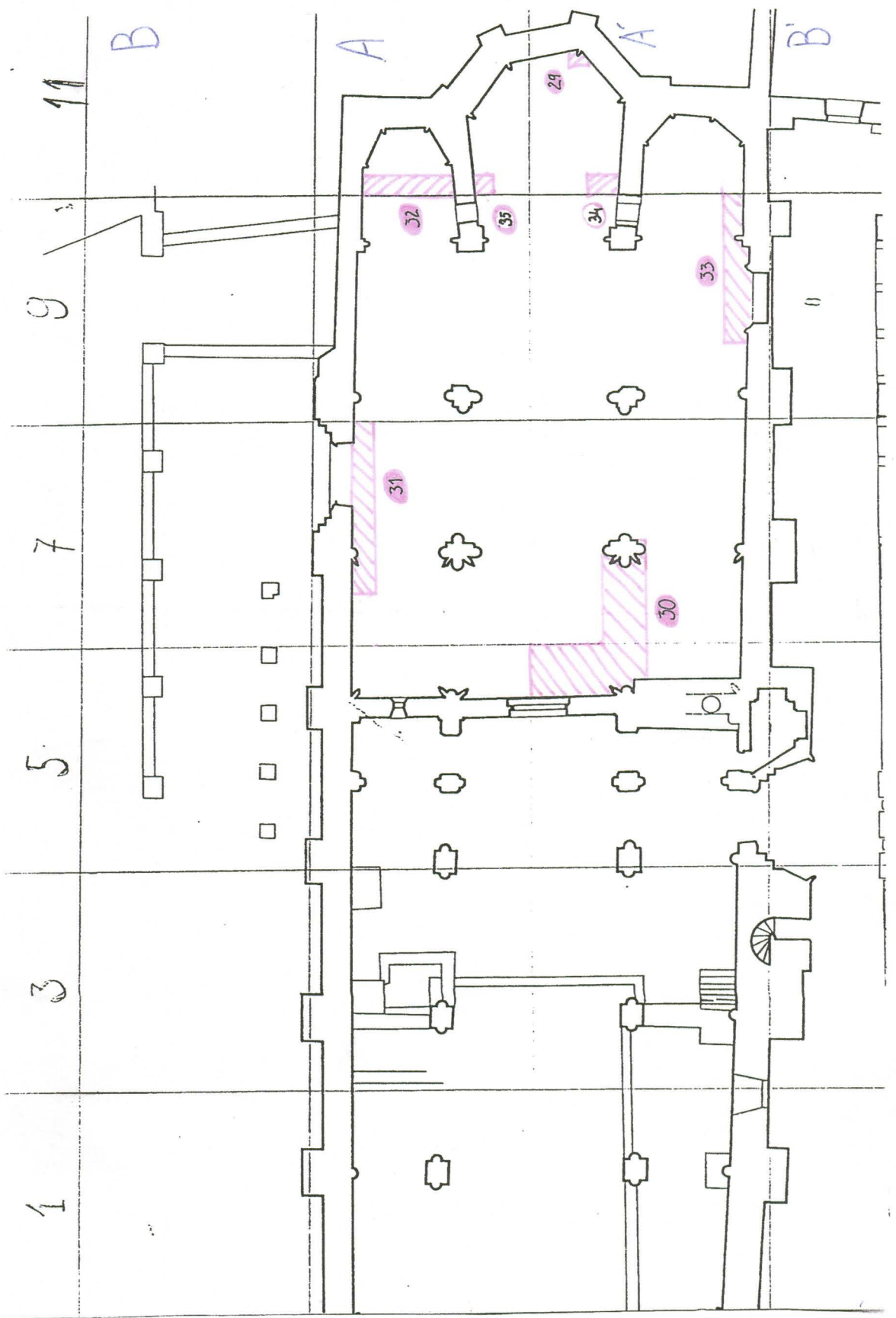

Novas áreas cercadas / demarcadas:

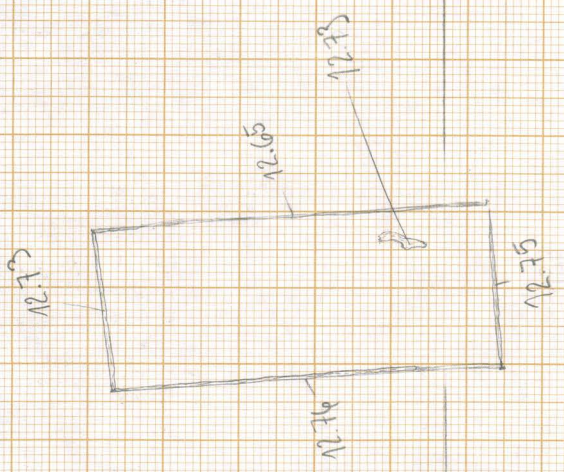

← Localização do 129º um
relatório ao observado.

SCU / 99
Soma N: 32 - E09 71
100 - 1/20 → N
29 de Março de 1999
Des: Mônica Gimpa

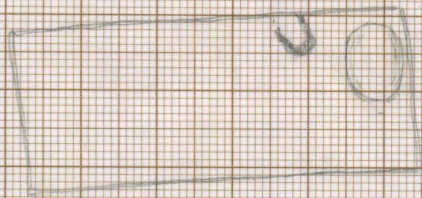
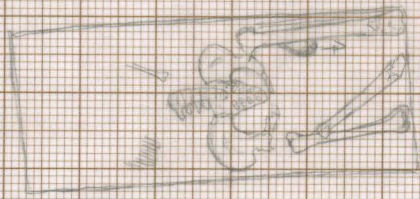
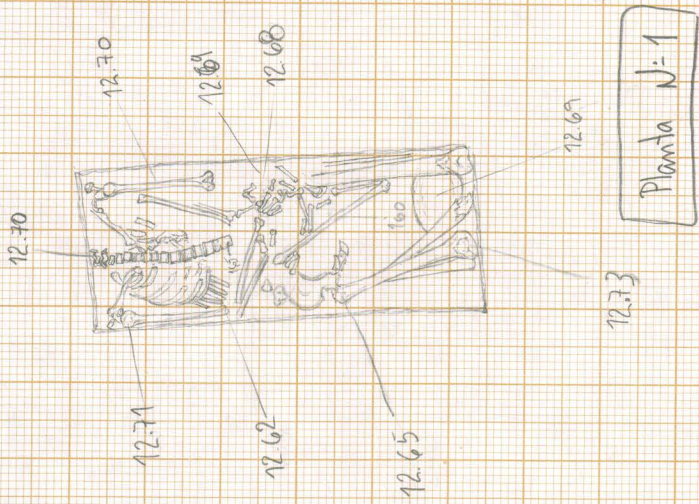

SCV / 99
 Sem. N: 32 - Eq. 71
 Doc. 1/120
 29 de Março de 1999
 Des: Mônica Gomes

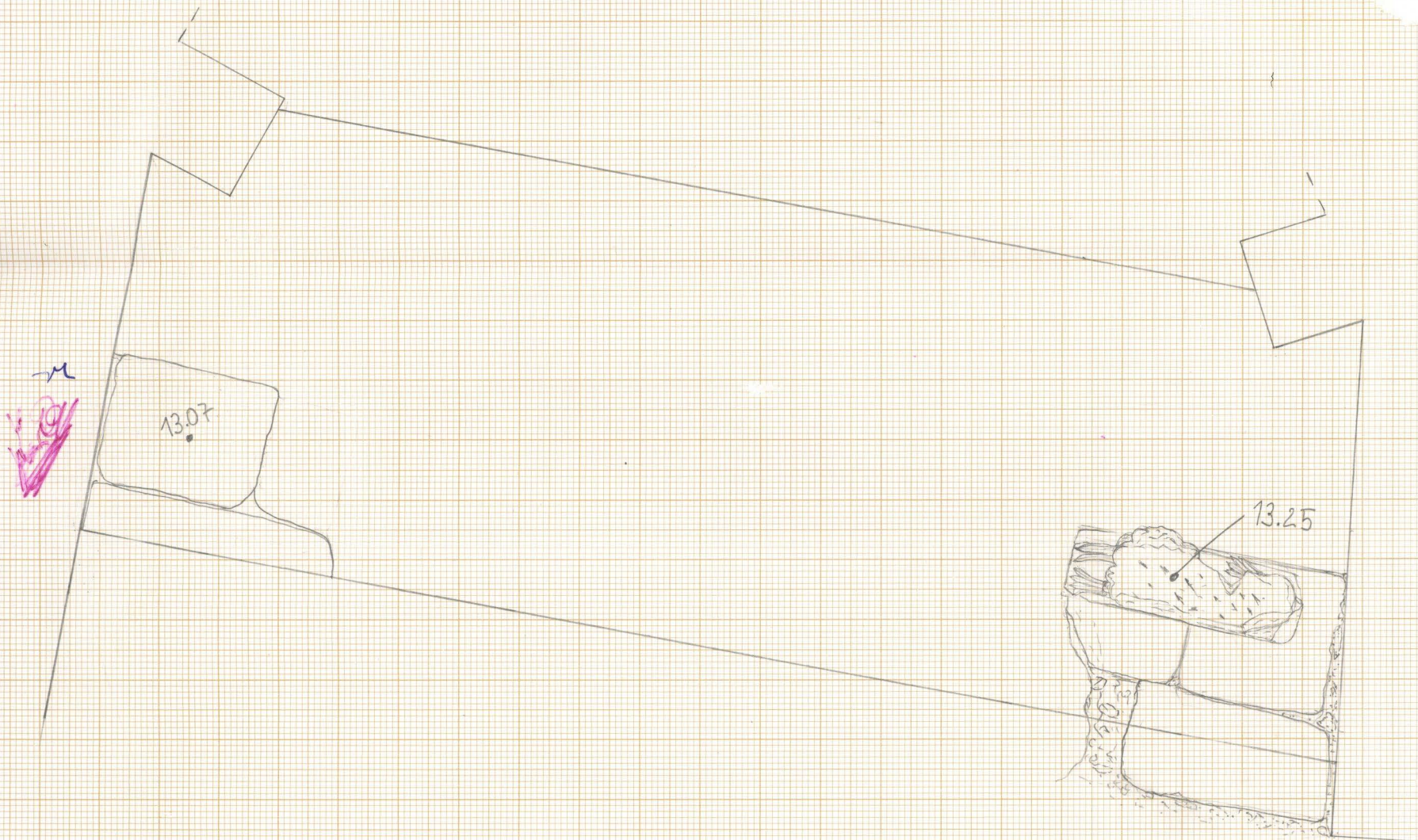

SCV / 99
Sond. N-32
Planta N-1
Esc. 1/20 ↗ N
DES: Mónica Gimja

S.C.V. 99
 Sond. N.º 32
 - Planta N.º 2
 5 de Março de 1999
 Des: Mariana Gimpa

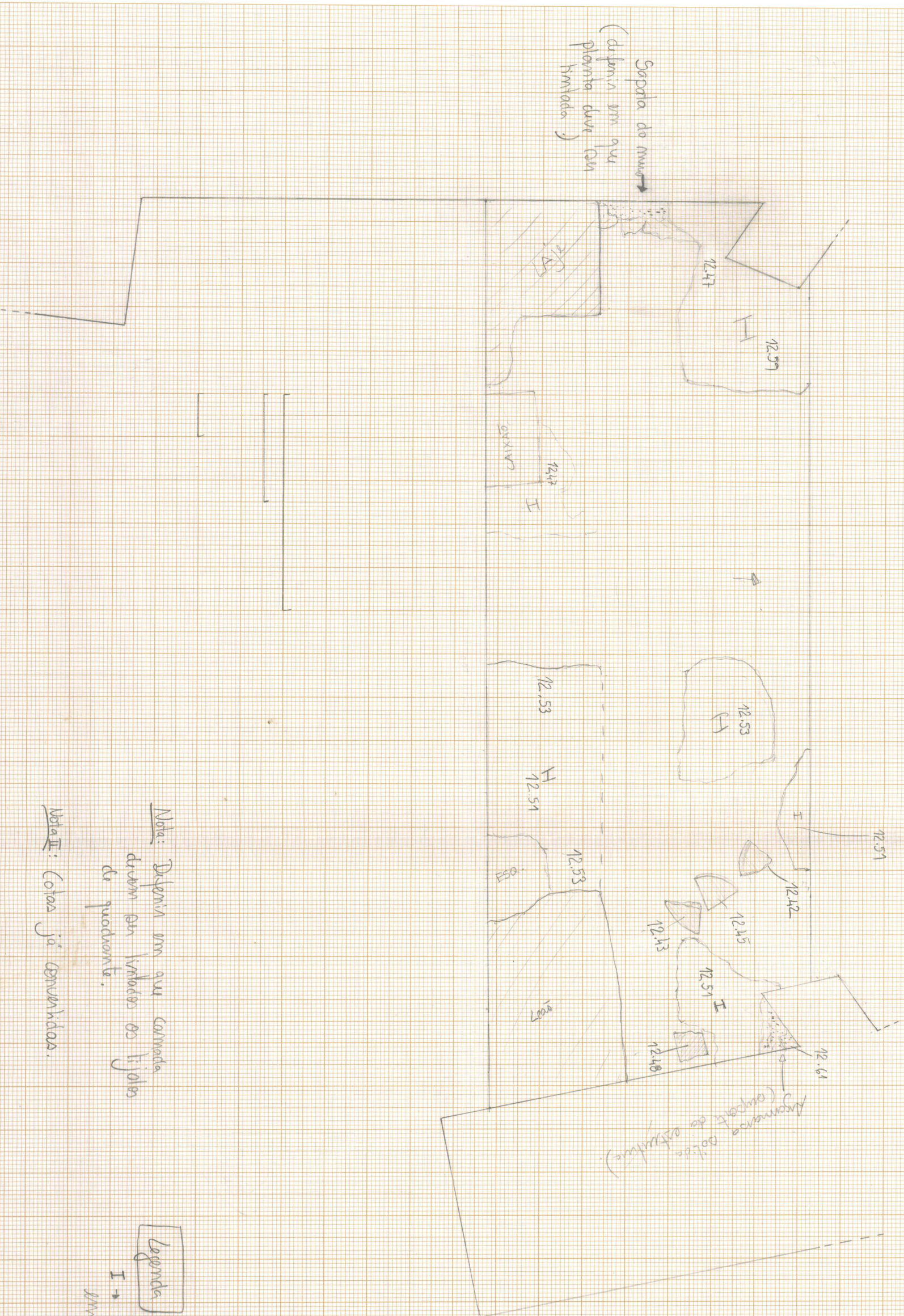

Nota: Diferença em que camada deve ser tomada os tipos de quadrante.

Nota II: Cotas já convertidas.

Legenda

I → Camada de acabamento (?) (ou colarinho) em desamperação.

~~21/03/99~~

SCU/99
Sond. N=32 \rightarrow N
[Planta N=3] ex: 120
8 de Junho de 1999
DES: Nénica Gimic

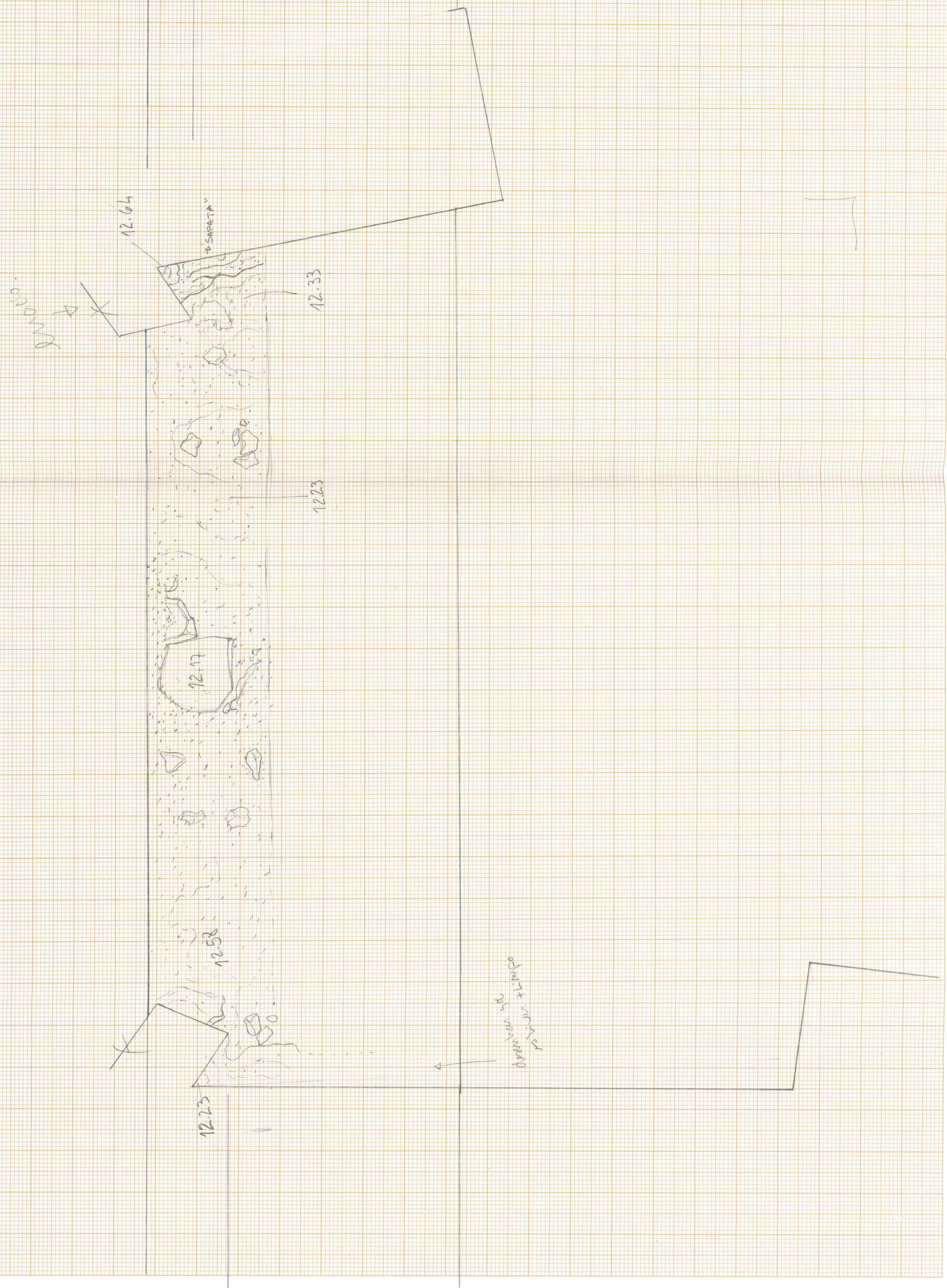

SCV - Estratigrafia - Sand. N.º 32 (aproximado ao CORTE C-D)

resposta

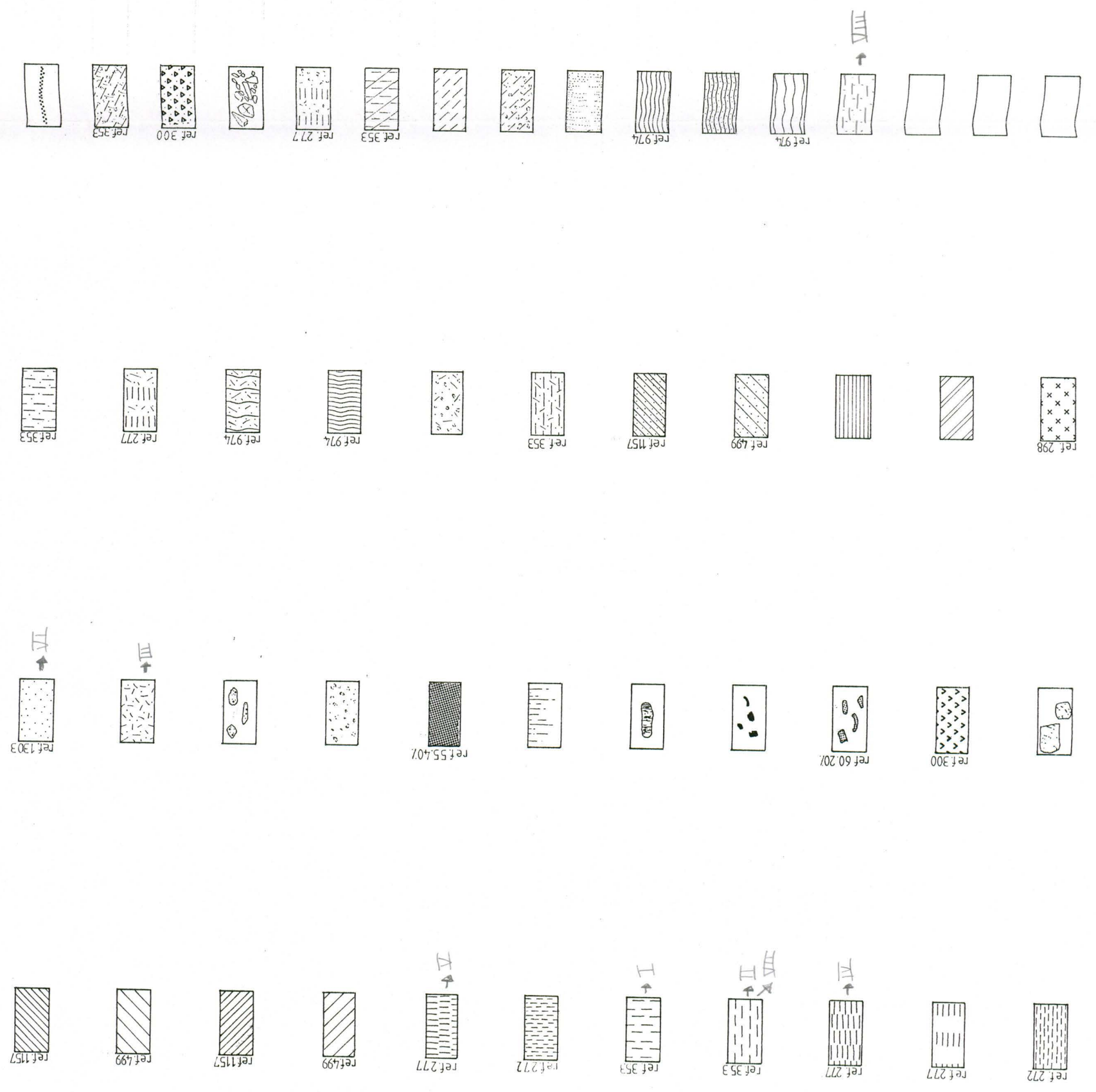

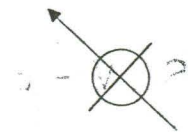

0 1m

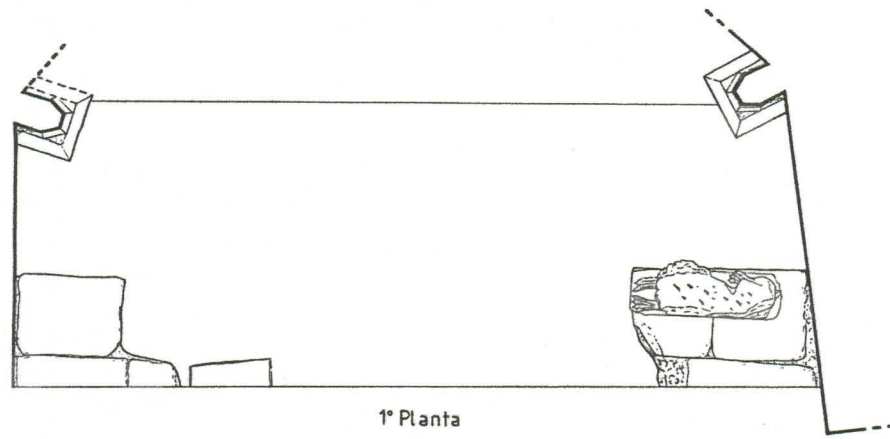

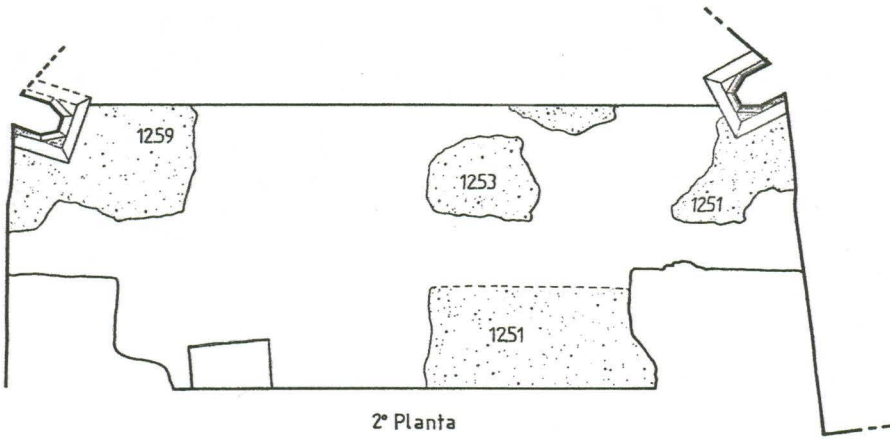

1ª Planta

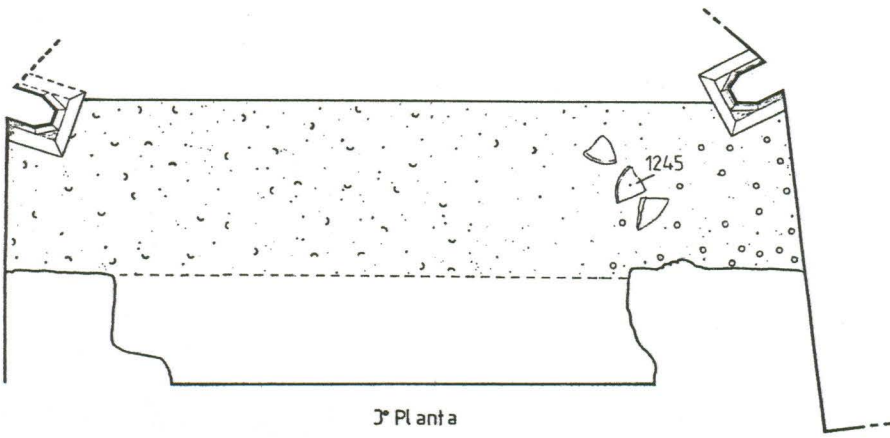

2ª Planta

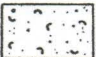

3ª Planta

-  - Fuligem
-  - Grés
-  - Argamassa

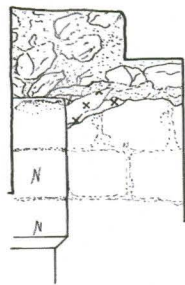
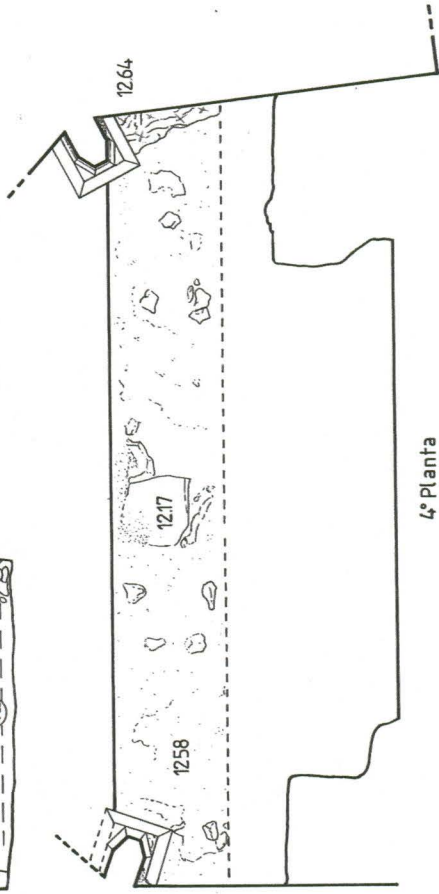
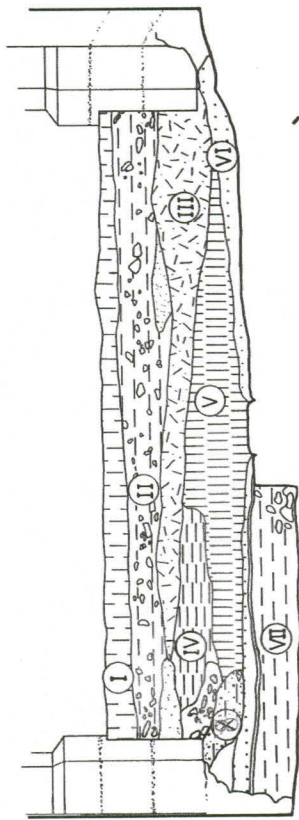

1307

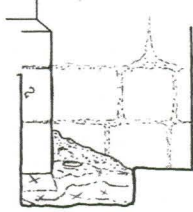

falle rotas
(miser. 600)
(13.10 just. i pancia)