

V13 ALÇADO EXTERIOR

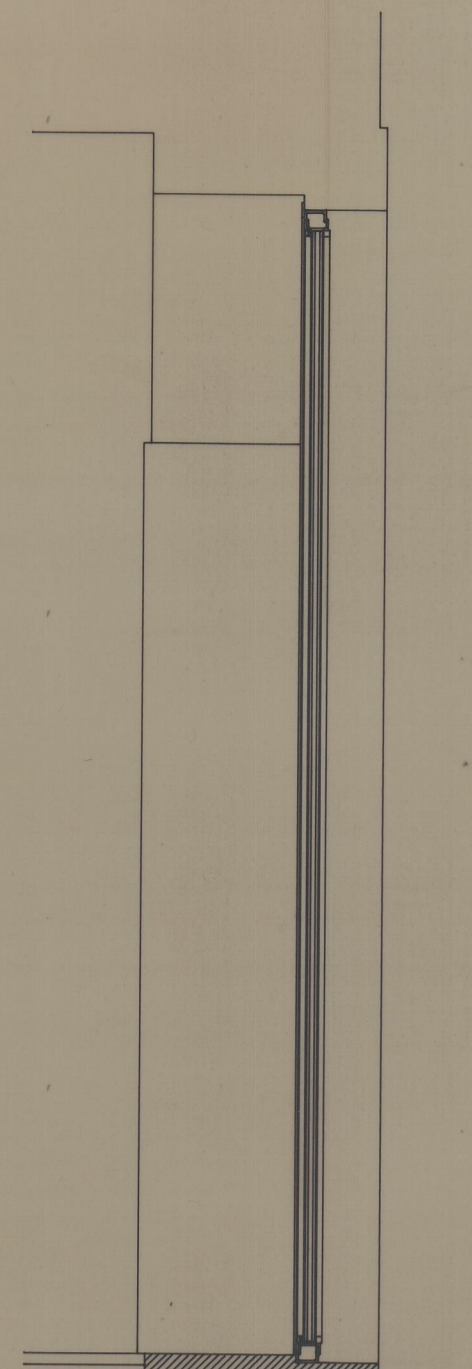

V13 CORTE

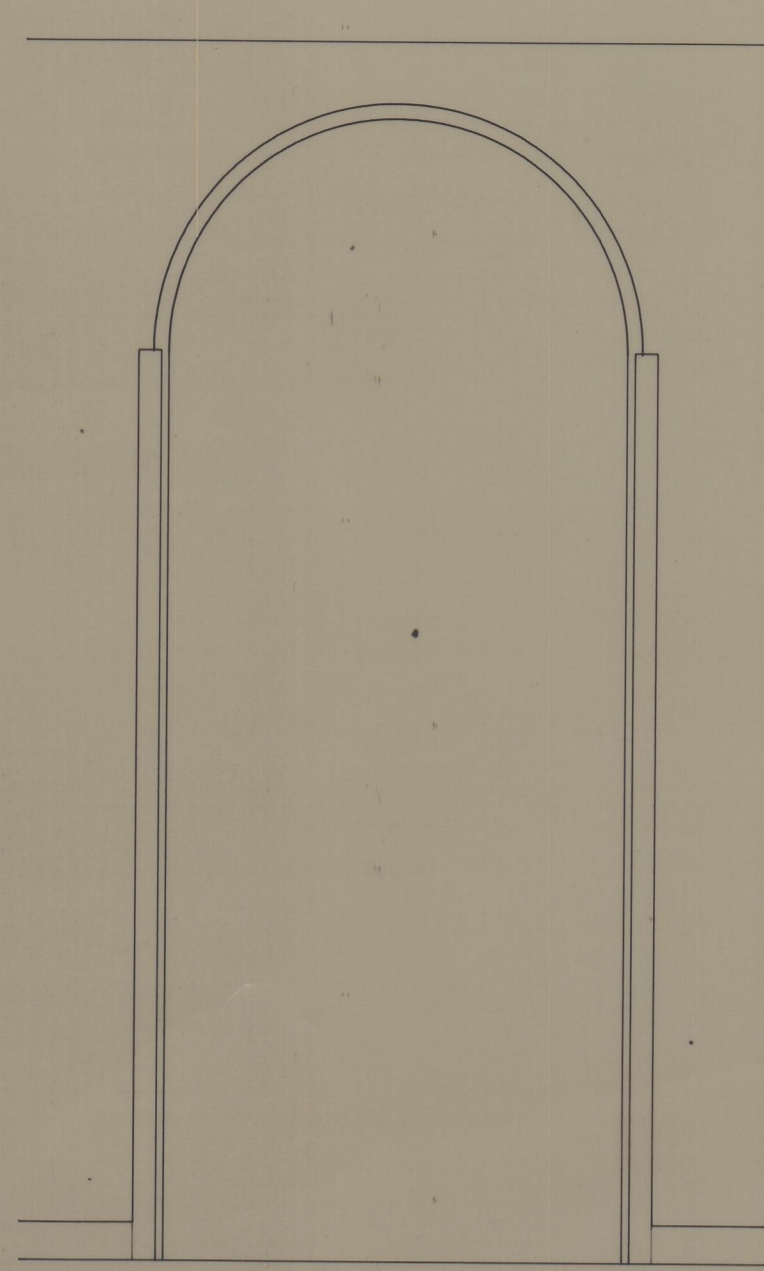

V13 ALÇADO INTERIOR

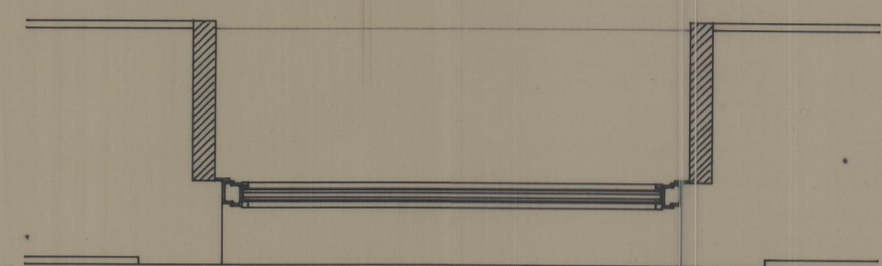

V13 PLANTA

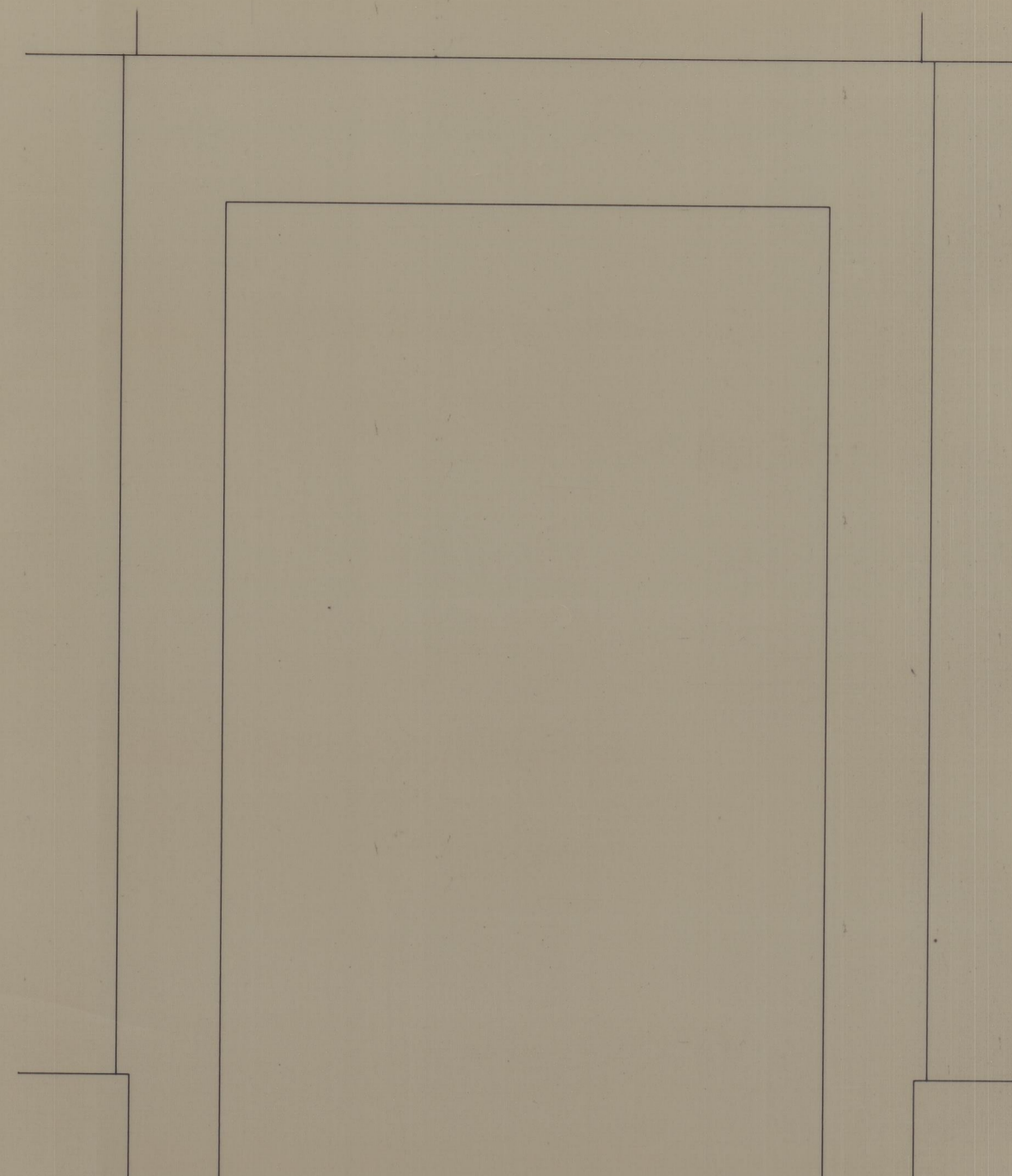

V12 ALÇADO EXTERIOR

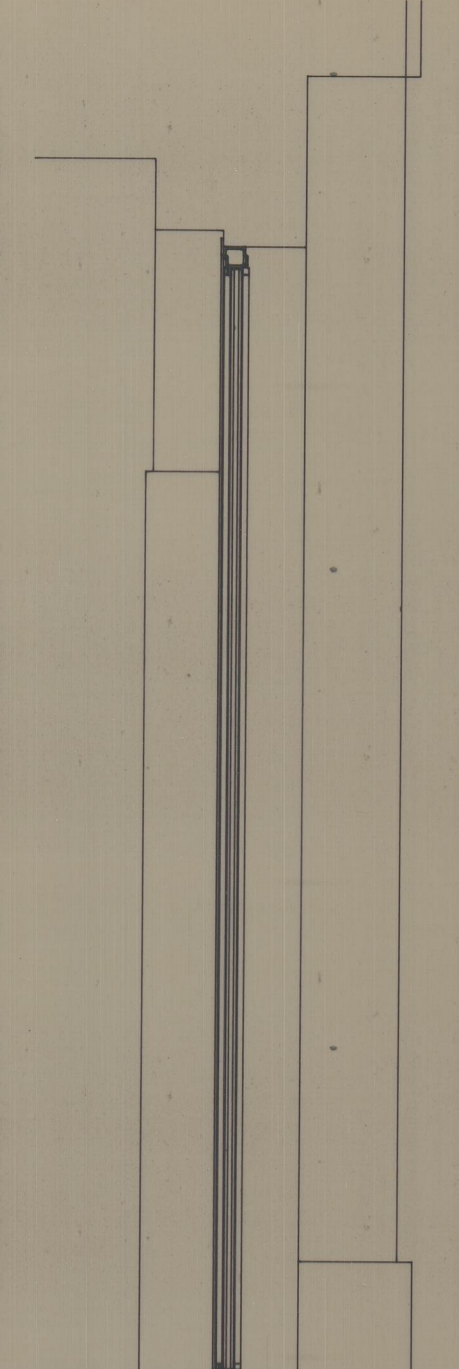

V12 CORTE

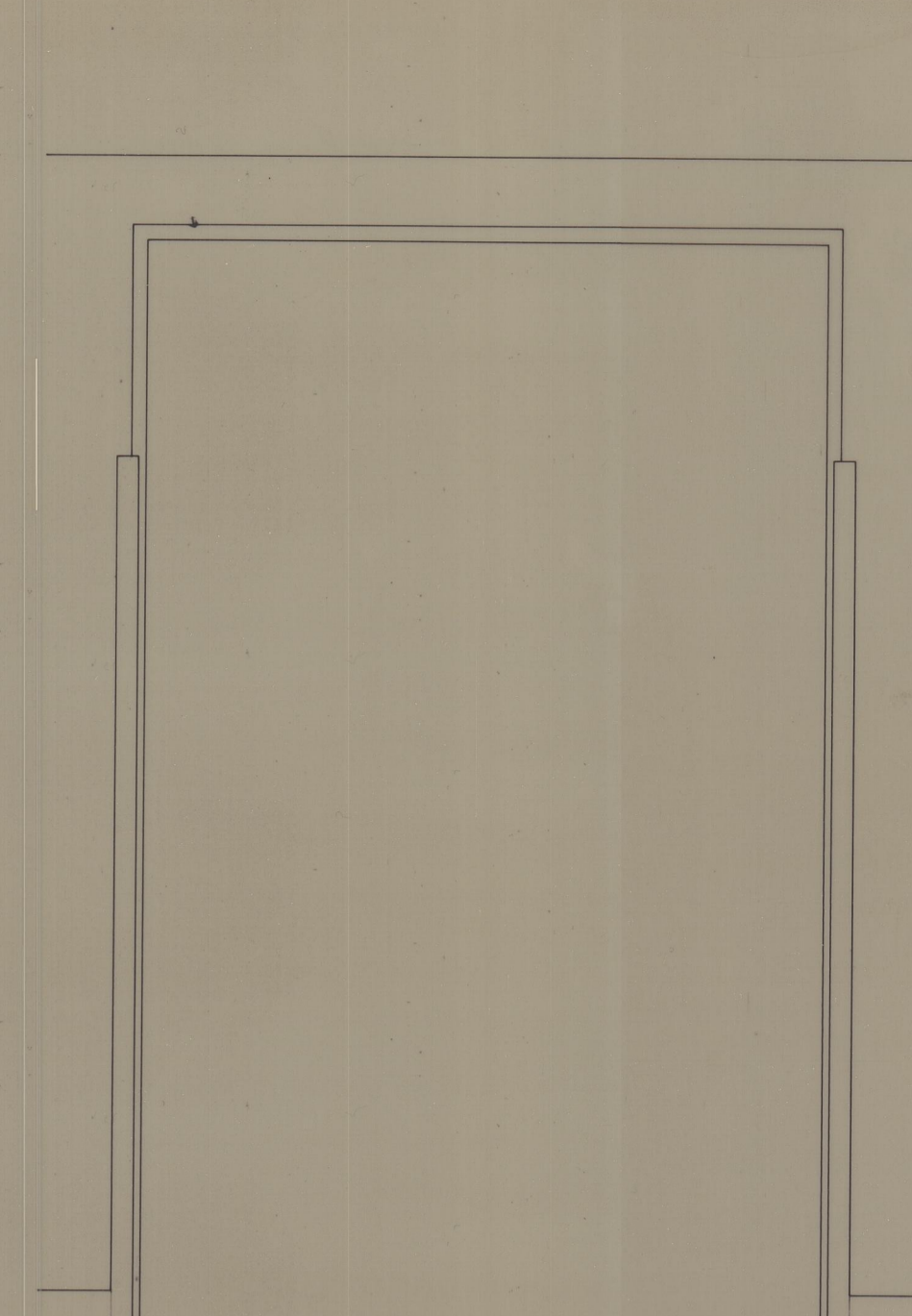

V12 ALÇADO INTERIOR

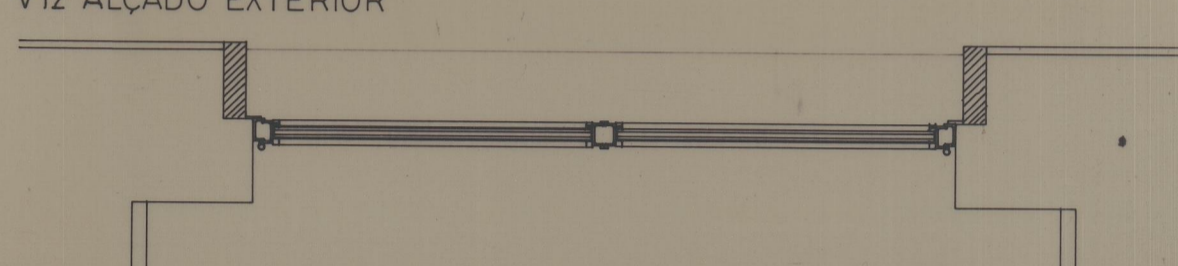

V12 PLANTA

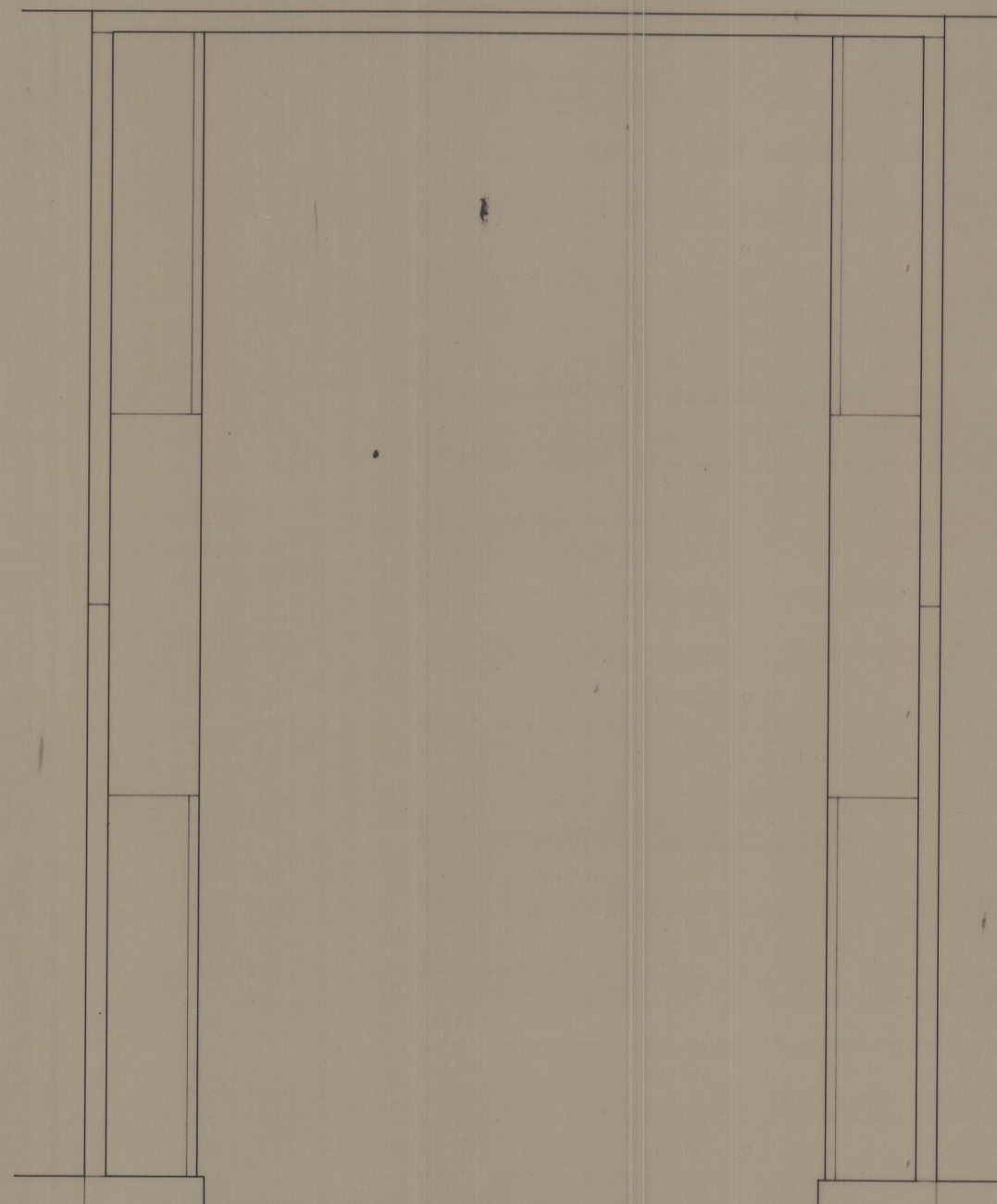

V8, V9, V10 ALÇADO

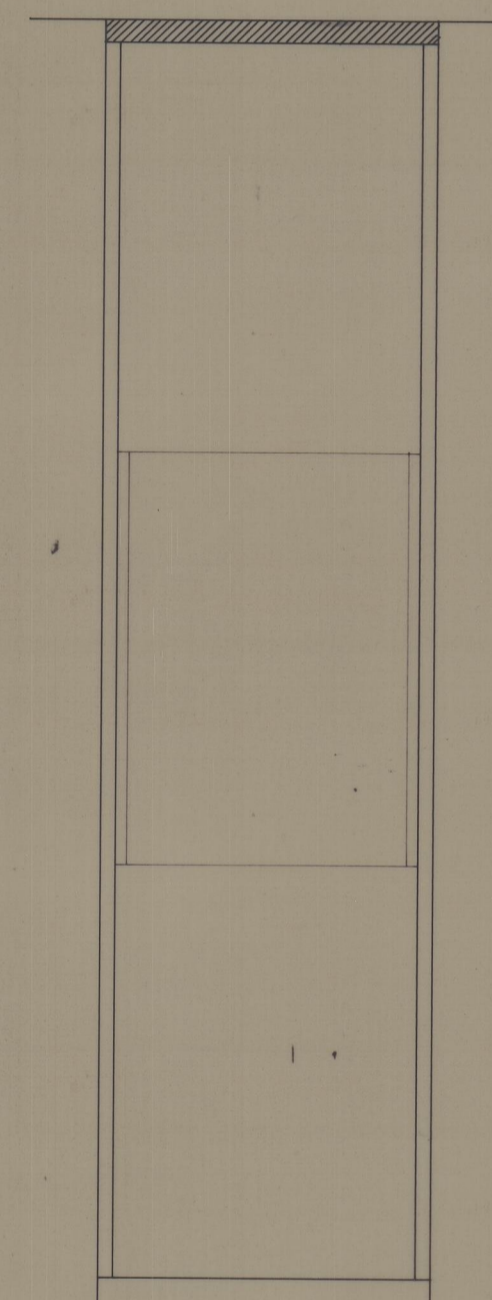

V10 CORTE

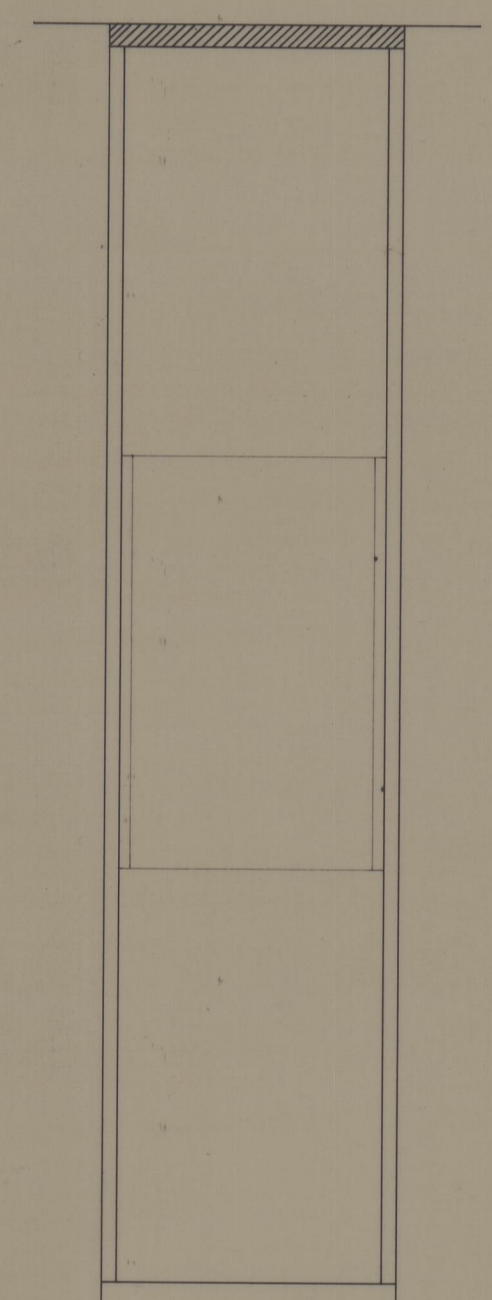

V9 CORTE

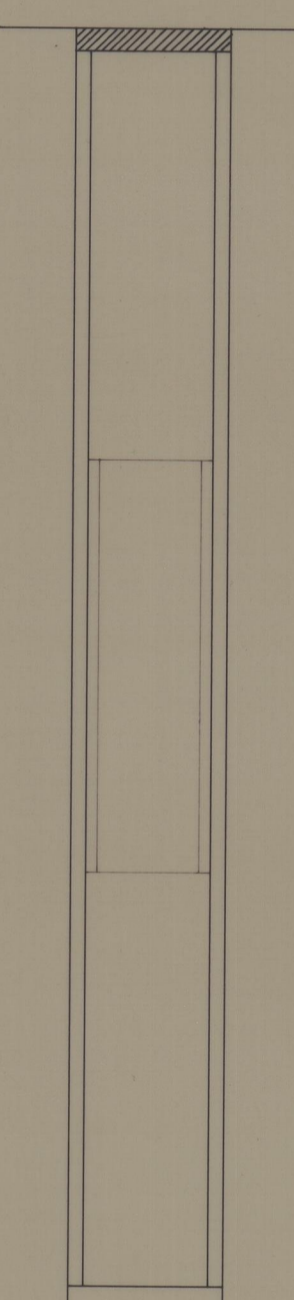

V8 CORTE

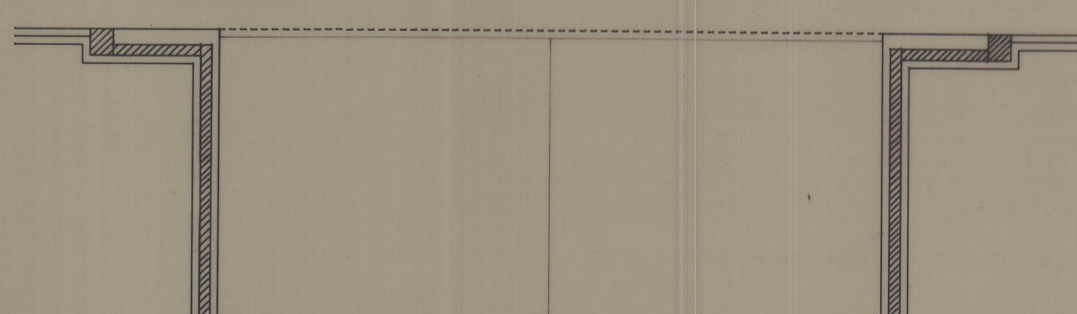

V10 PLANTA

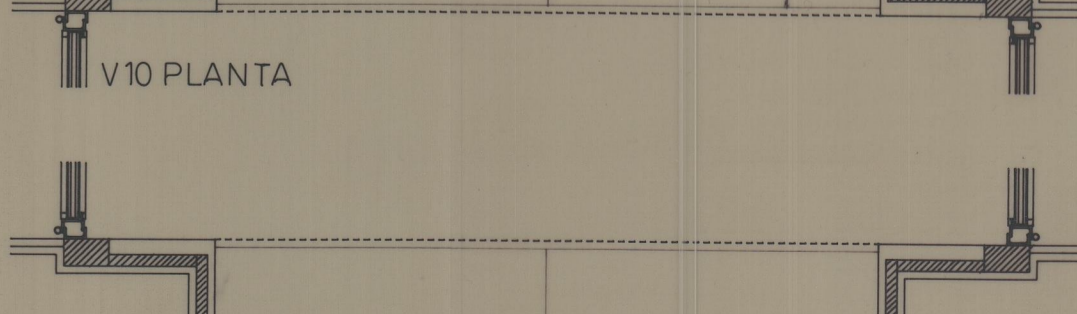

V9 PLANTA

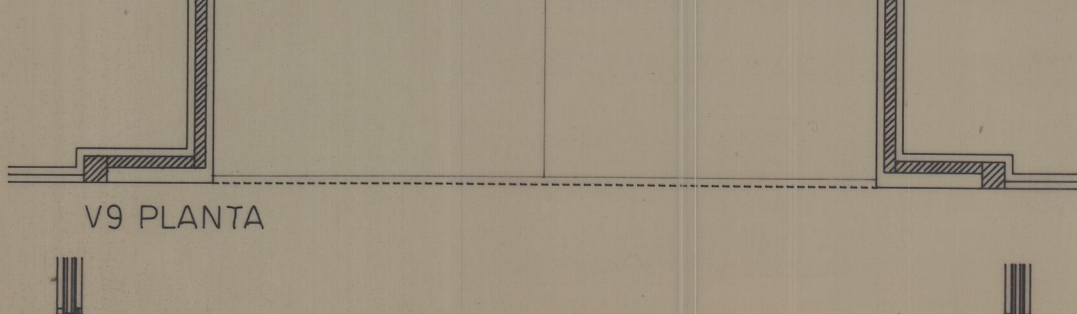

V8 PLANTA

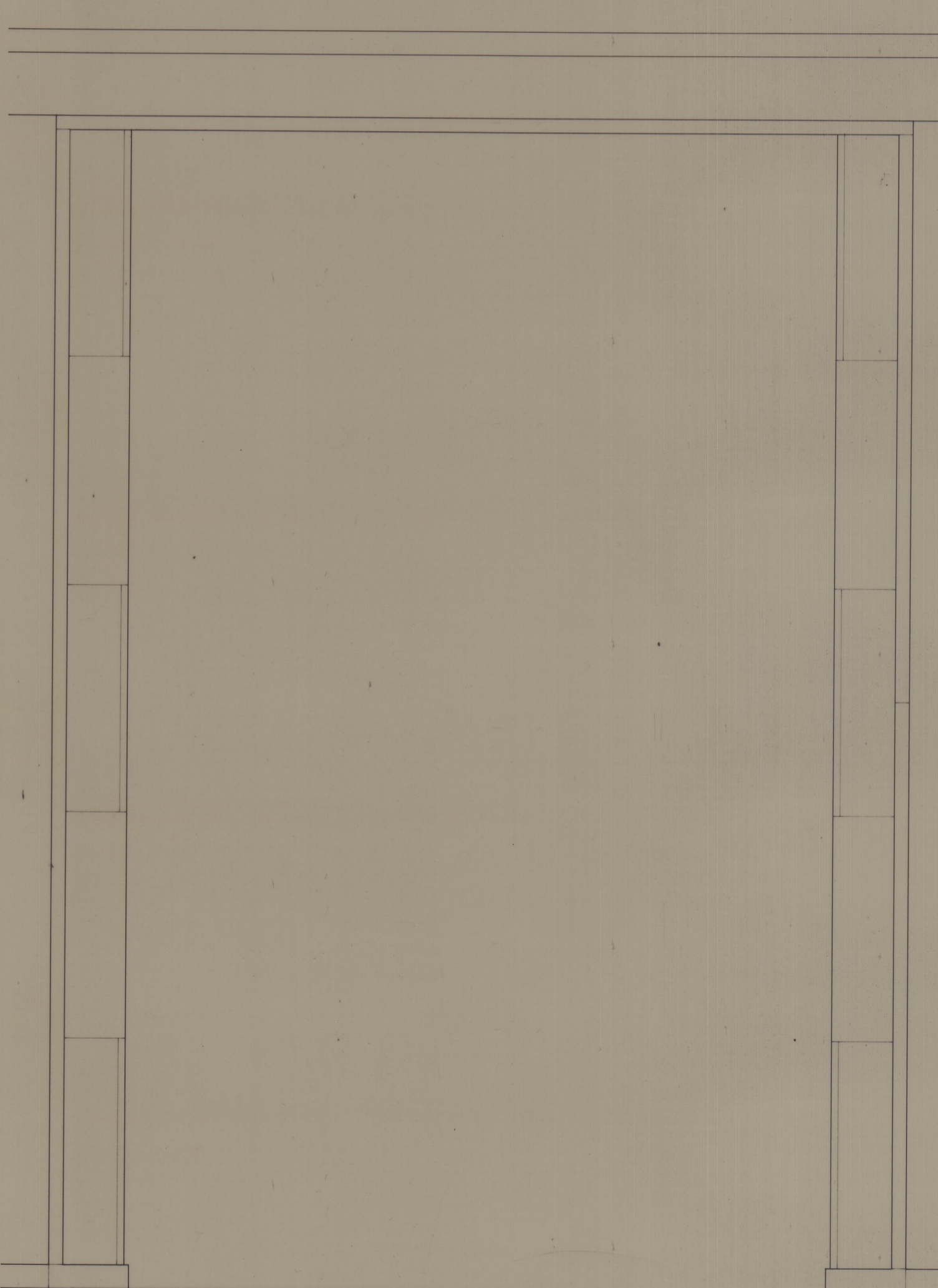

V11 ALÇADO

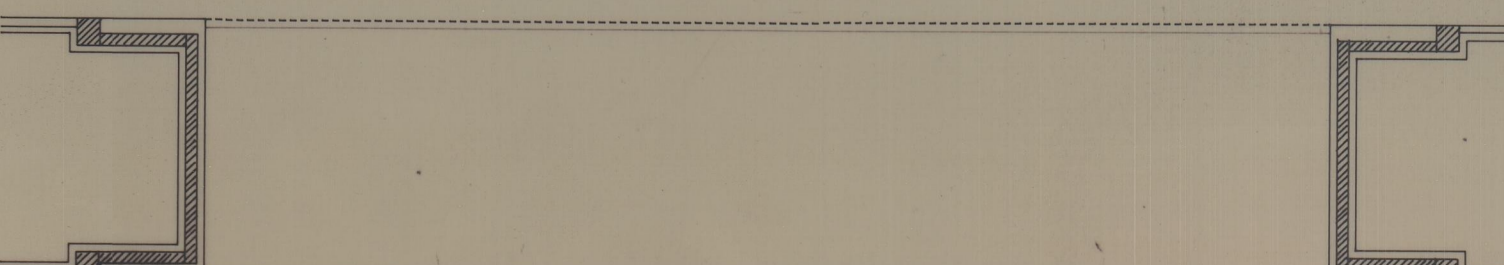

V11 PLANTA

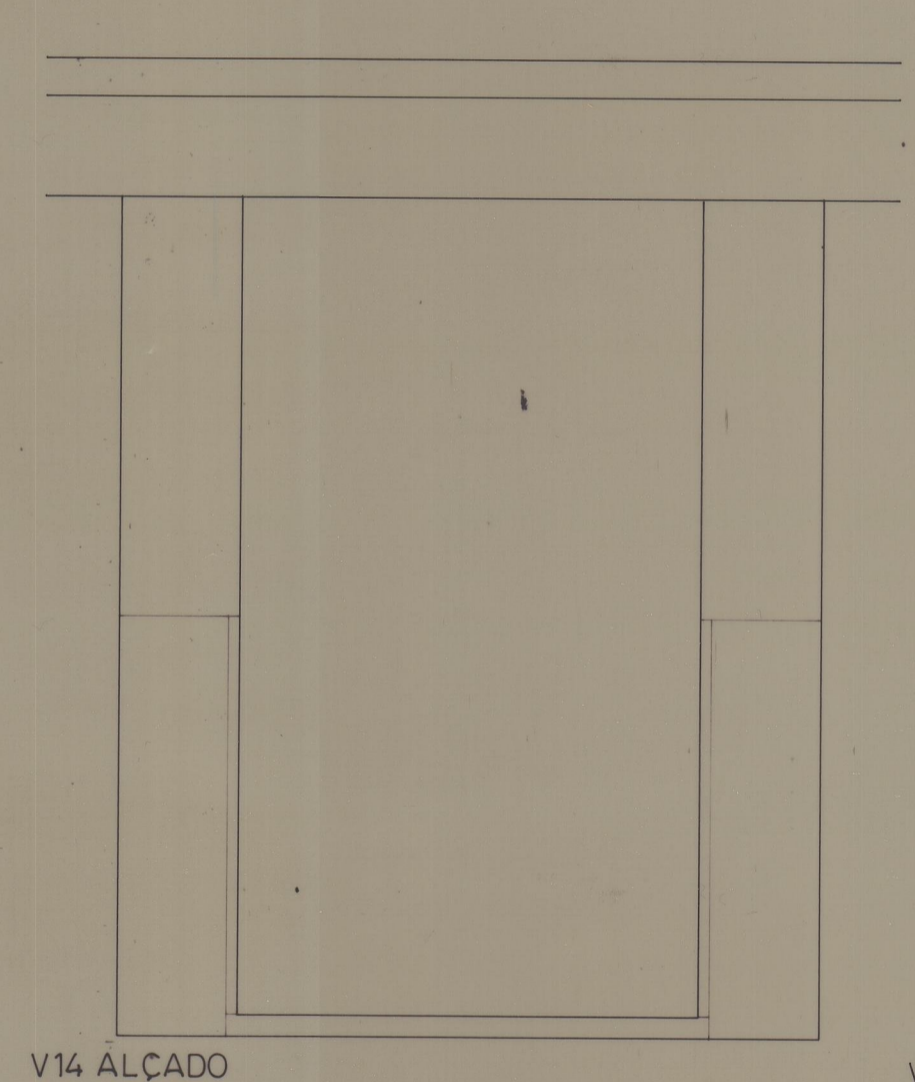

V14 ALÇADO

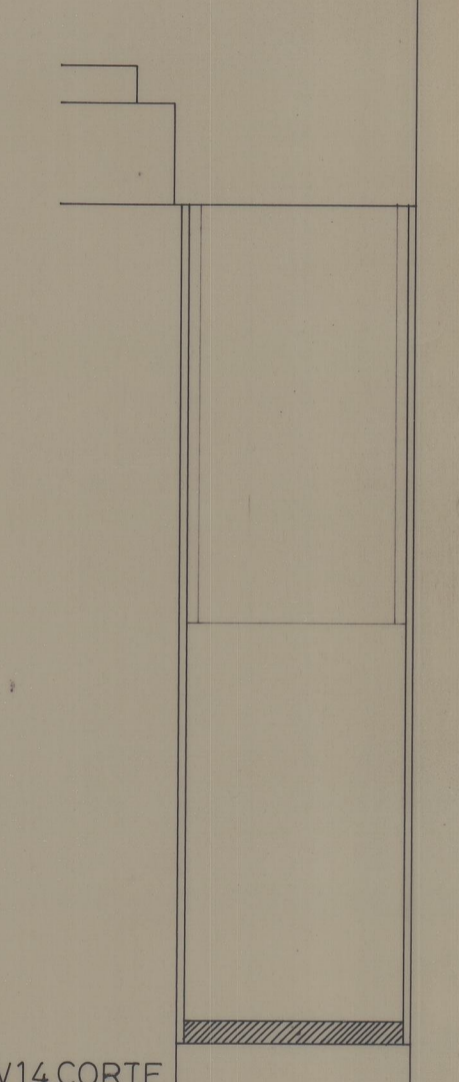

V14 CORTE

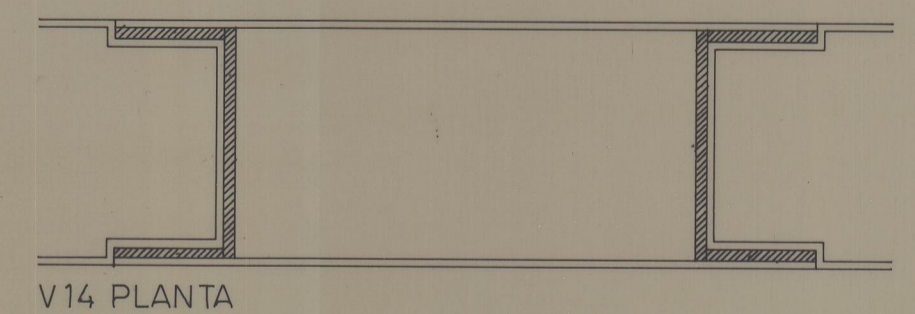

V14 PLANTA

GRANITO AMARELO OU CINZA, POLIDO

INSTITUTO PORTUGUÊS DE MUSEUS
INST. PORT. DO PATRIMÓNIO ARQUITECTÓNICO E ARQUEOLÓGICO
MUSEU NACIONAL SOARES DOS REIS
PROJECTO DE REMODELAÇÃO / 4ª FASE
MARMORISTA - VÃOS V

F. TÁVORA, arq.
JANEIRO 1993
DESENHO 243 PE4.29
ESCALA 1/20

2007
41-1987