

S.C.V. 98 9 N MC. 1/20
 Sond. N: 6

5/197 1/20 sondagen in 6 Punkte

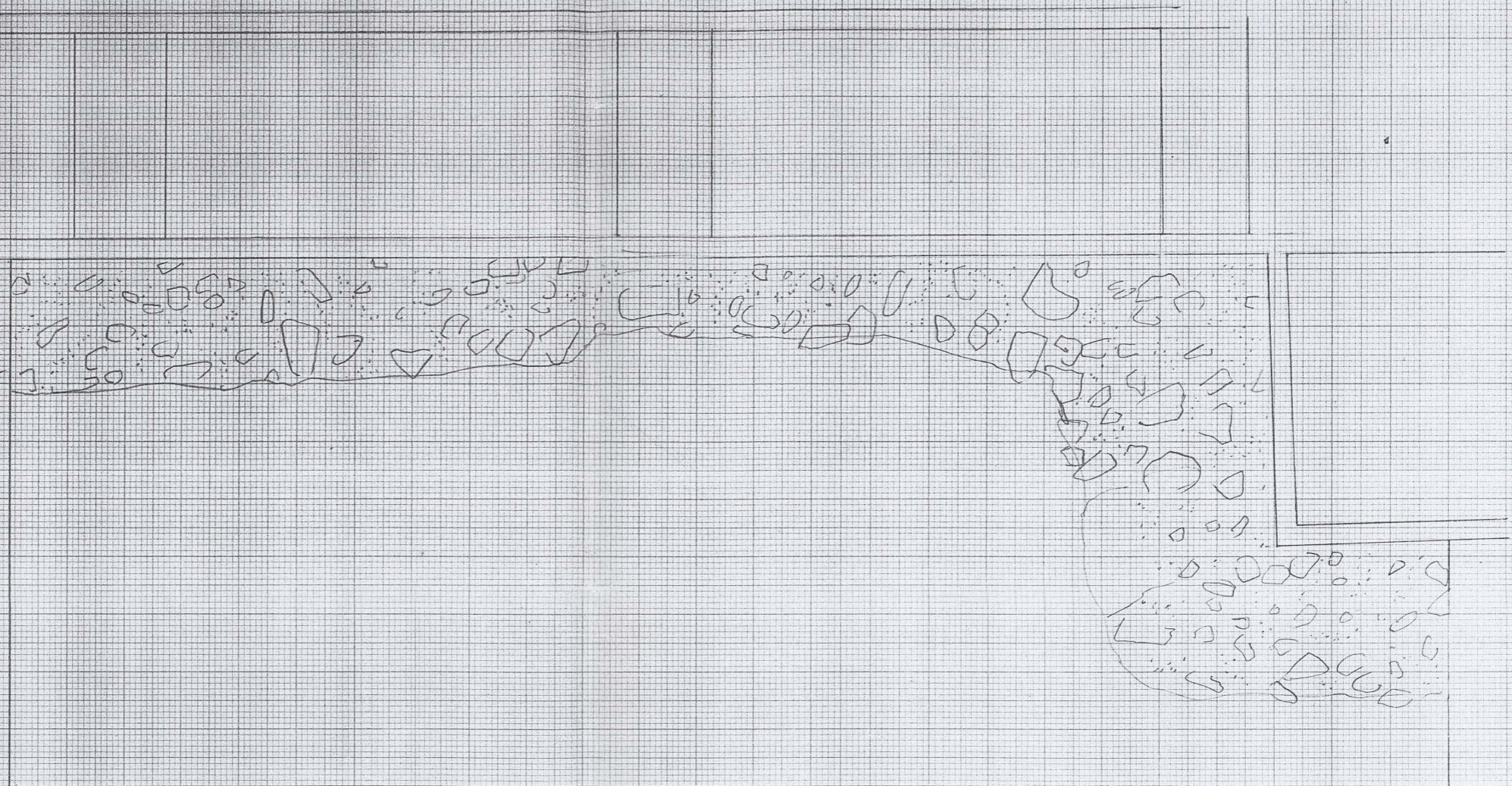

SECT. 17. ESC. 1/70 E. N. de Q. B. I. IV
Sondagem n. 6

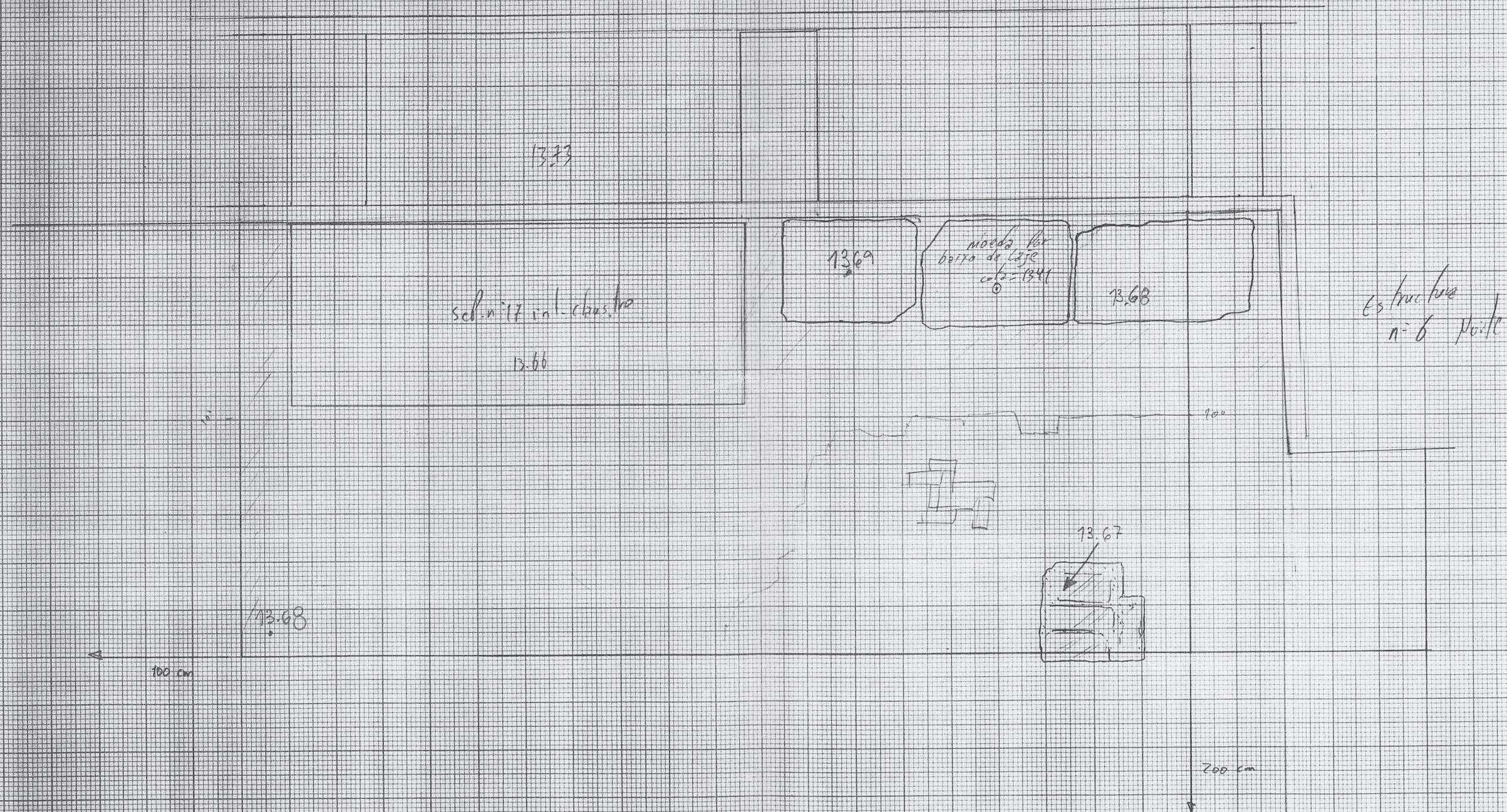

SCV 97

→ Norte 1/20

Sondagem
n.º 6

506

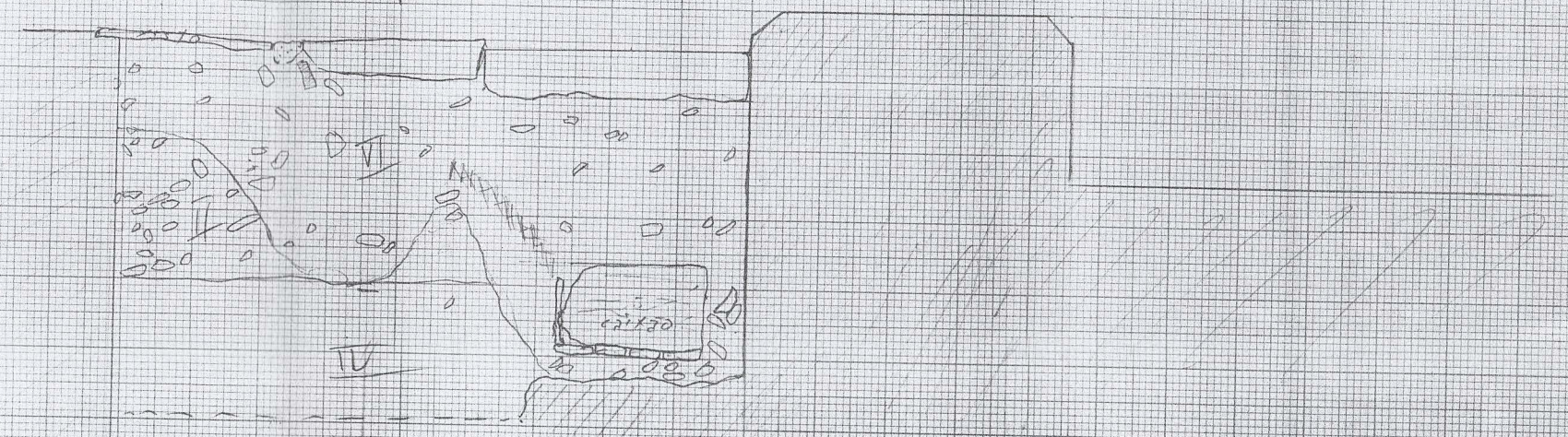
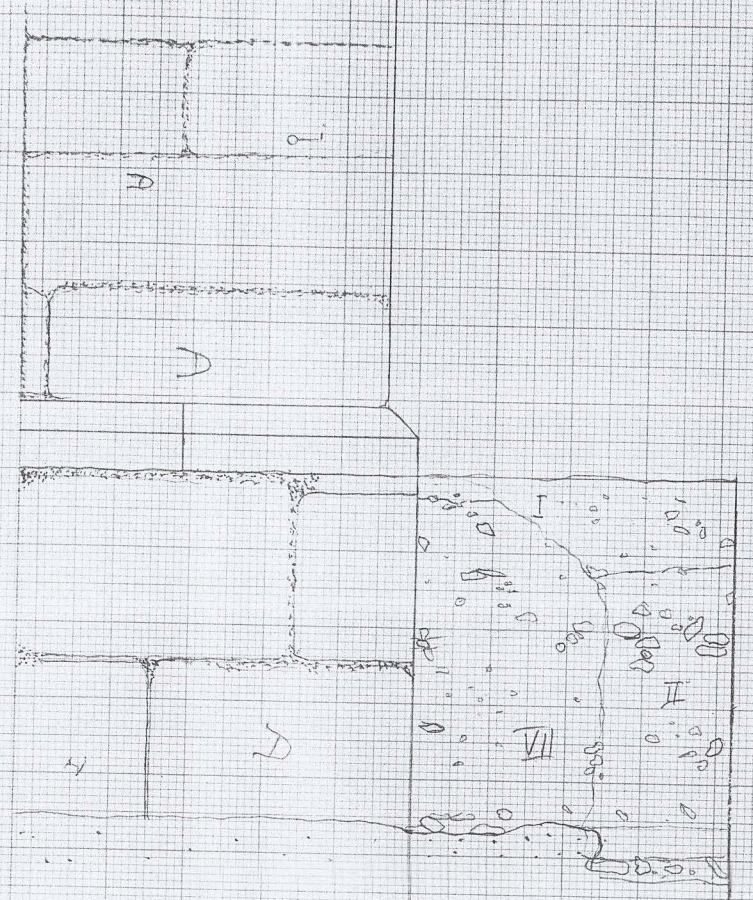

VI - Terra igual à camada II apresentando, no entanto, elementos carbonizados na parte superior que lhe conferem uma tonalidade cinzenta que progressivamente se vai misturando com a mesma terra, decrescendo de cima para baixo.

VI - terra bastante compactada, granulometria muito fina com vestígios de fragmentos grosseiros, sendo a base dos mesmos fragmentos de calcário geralmente de seitas rotadas.

VII - fragmentos de terra amarelada que se misturam à camada...

Send. 6

978

→ Falta um a
est.

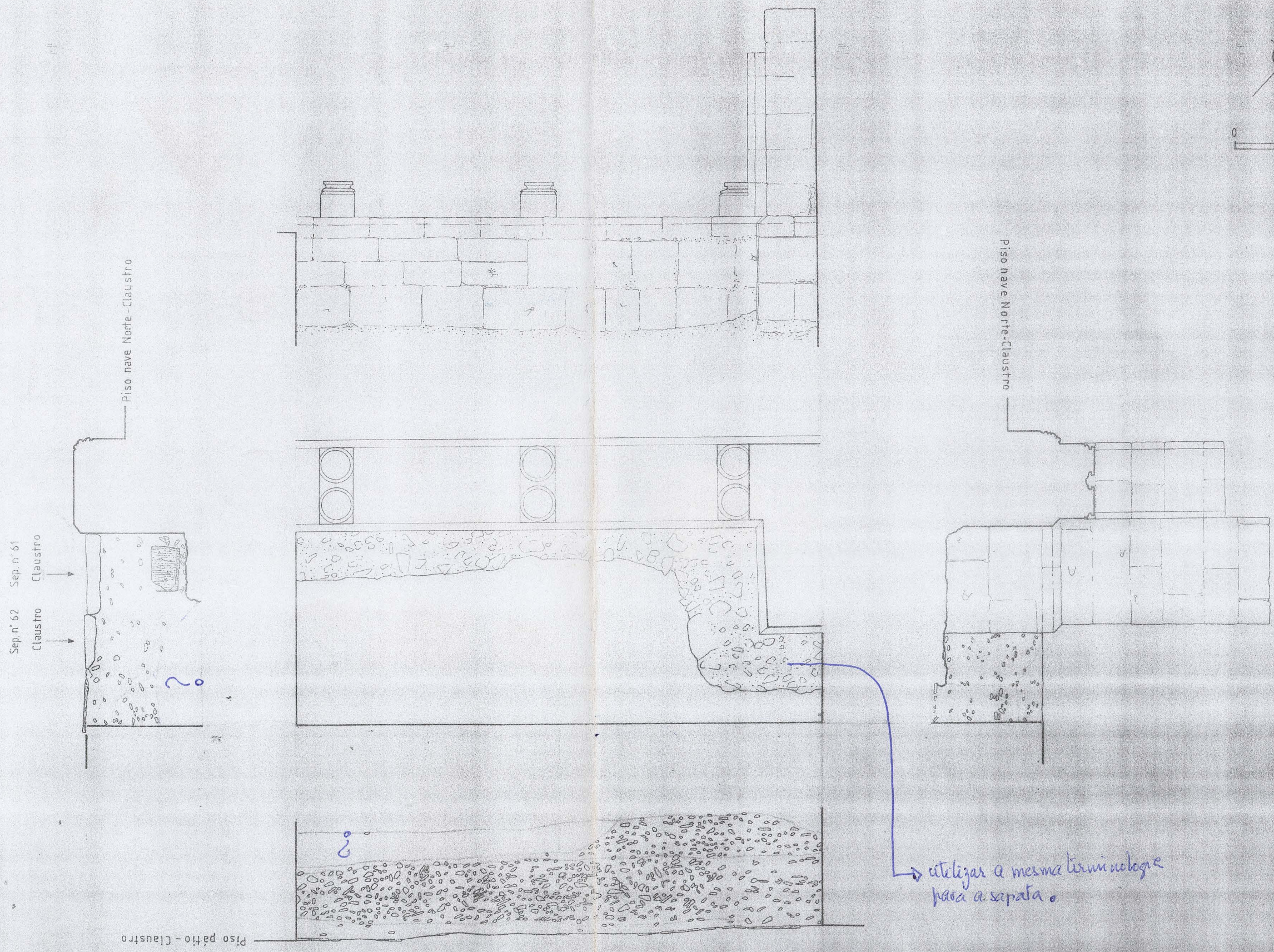
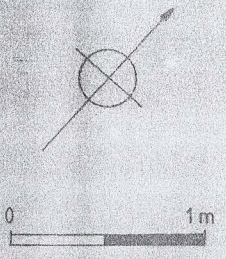

sendojean n.º 6 FN 1/100

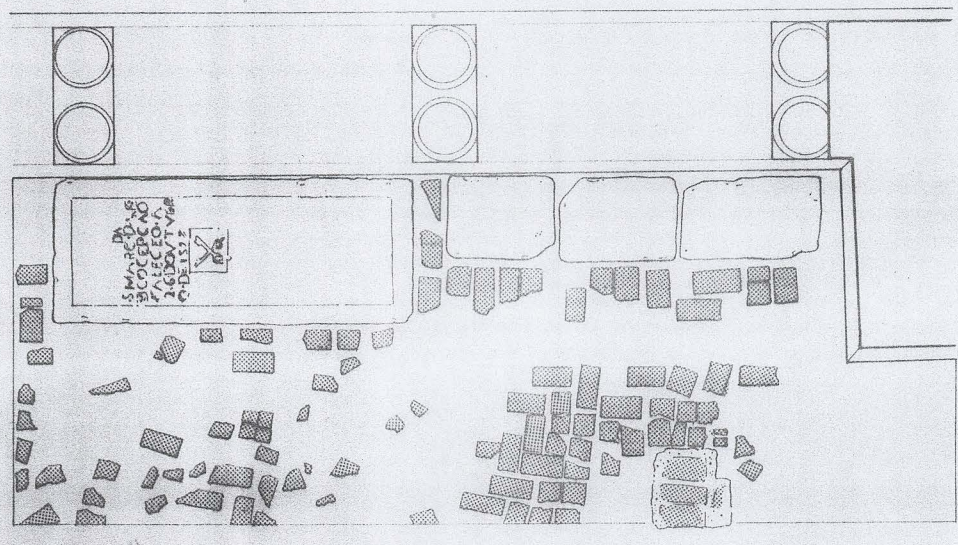
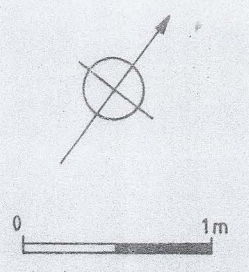

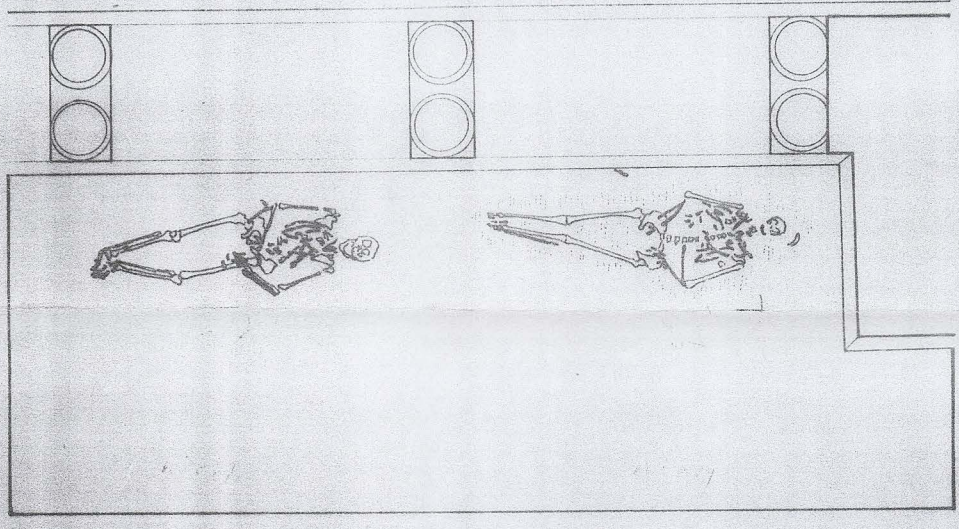

1ª Planta

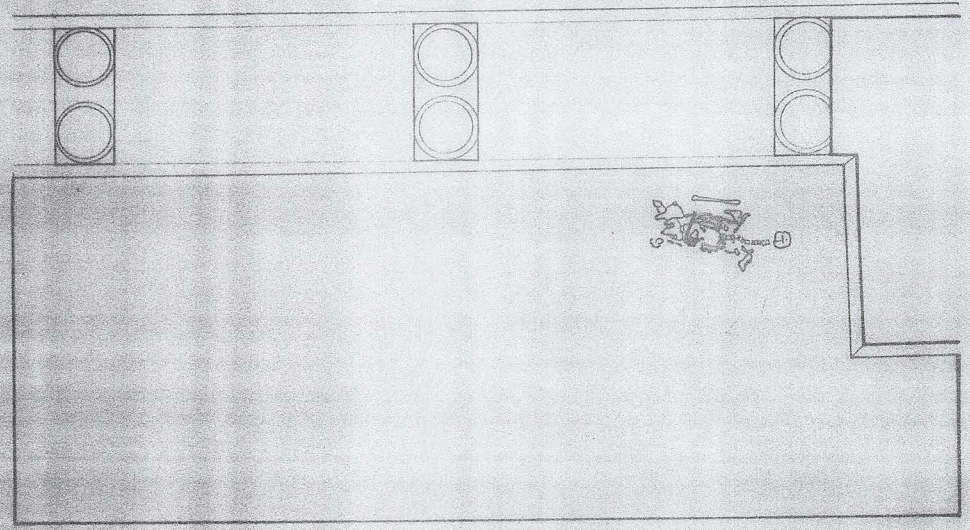

2ª Planta



3ª Planta

-  - Tijoleira
-  - Cal
-  - Atgamassa

Sondagem N° 6	SCV 98
	Des: <i>Roberto</i> <i>Mônica Guimarães</i>

b4b

S. C. U. 93

Esc. N. Esc. 1/20

Ser. n. 59

referente a sondagem n. 6

← norte

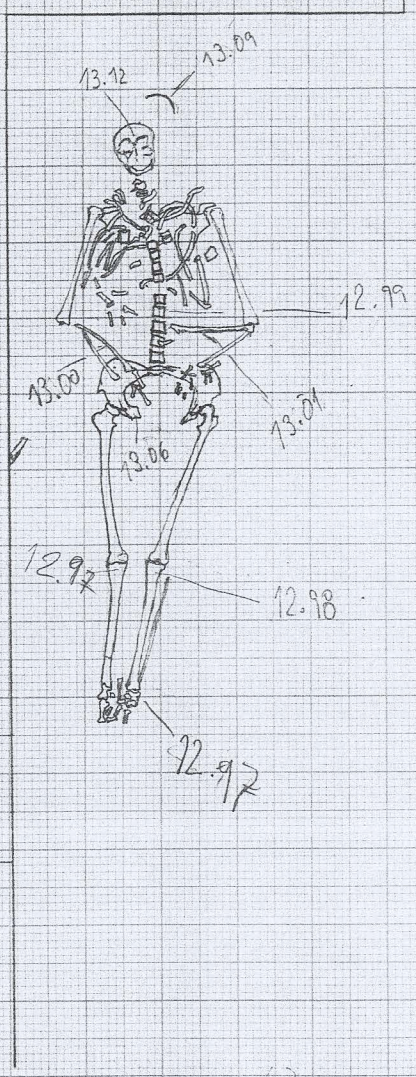

coluna
n. 43

coluna
n. 44

1350
463
15.13 - nivel

Csc. 1/70 3CV97
s.el. 17 (60)
rotorante a sandogam n.6

← Norte

colona
43

colona
44

1313

1314

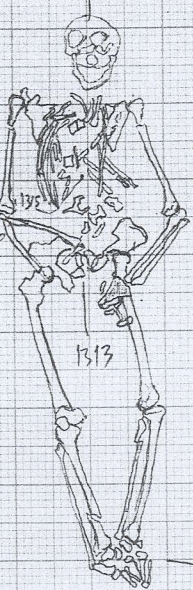

1317

1313

colona
45

colona
46

1319

982

Sond6

SCV 97 1/20

21/11/97

Sondagen n 6

Ser. n. 59 A claustra

← Norte

1550 + 163 = nivel

1513

