

IC. DE MEMÓDIO  
ESQUENA  
- SEQUENCIA RECEITAS  
- PRIMEIRA CAPA DE 150 TMSO  
Esc. 4:100

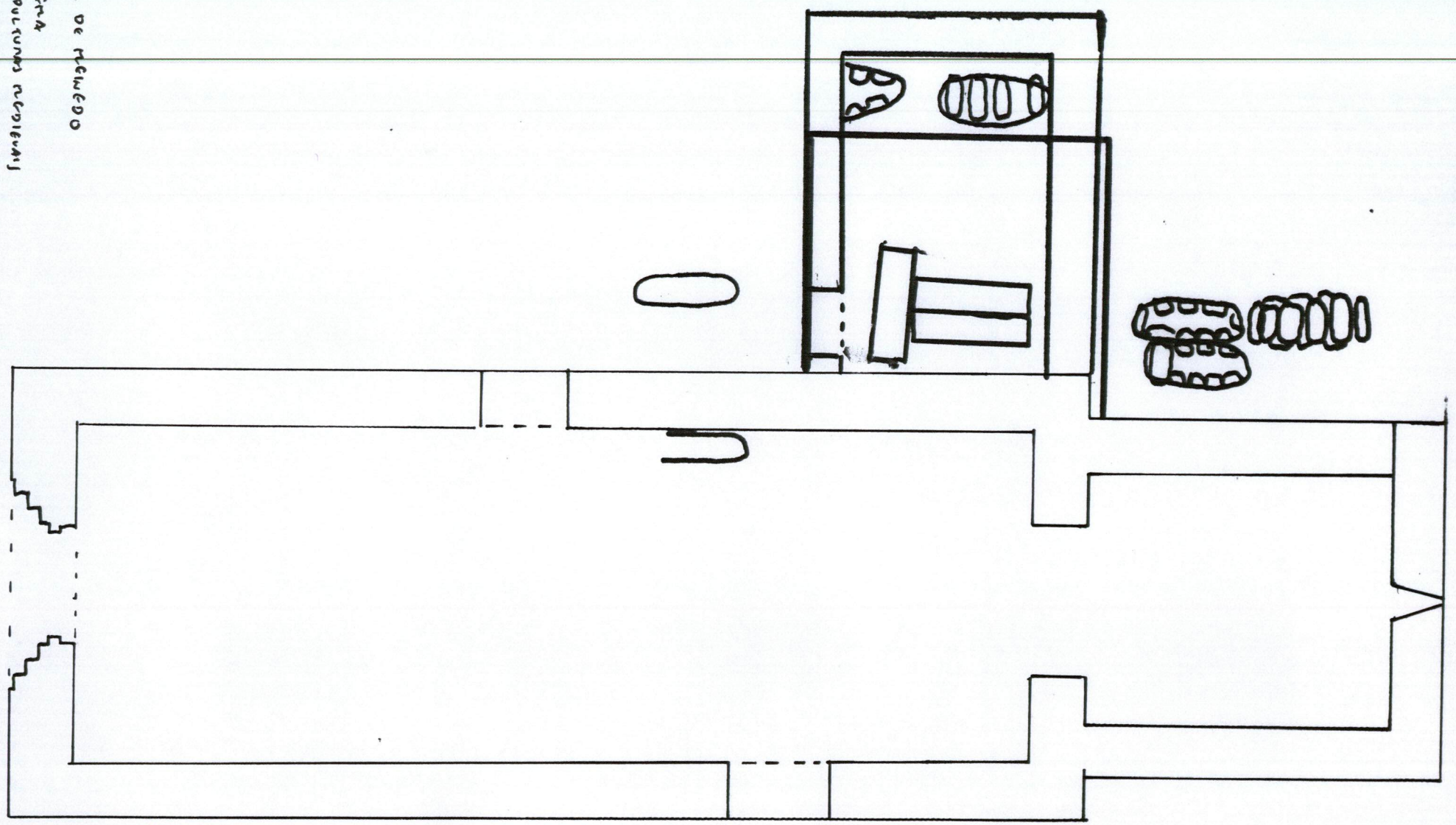

IG. DE NEWBRO  
CLAUENA 1.100  
- TENDLA PAI-MANDMILA

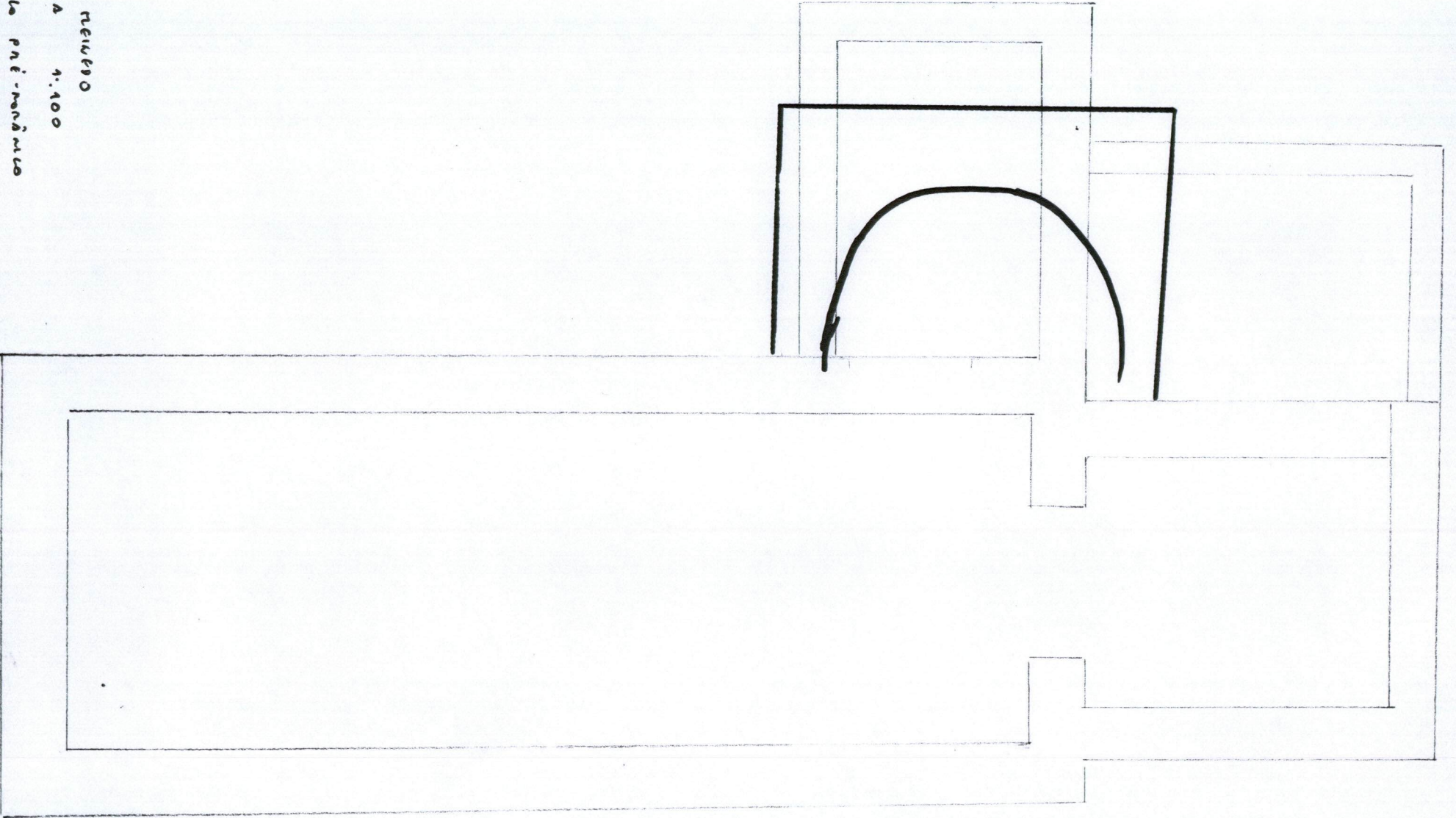

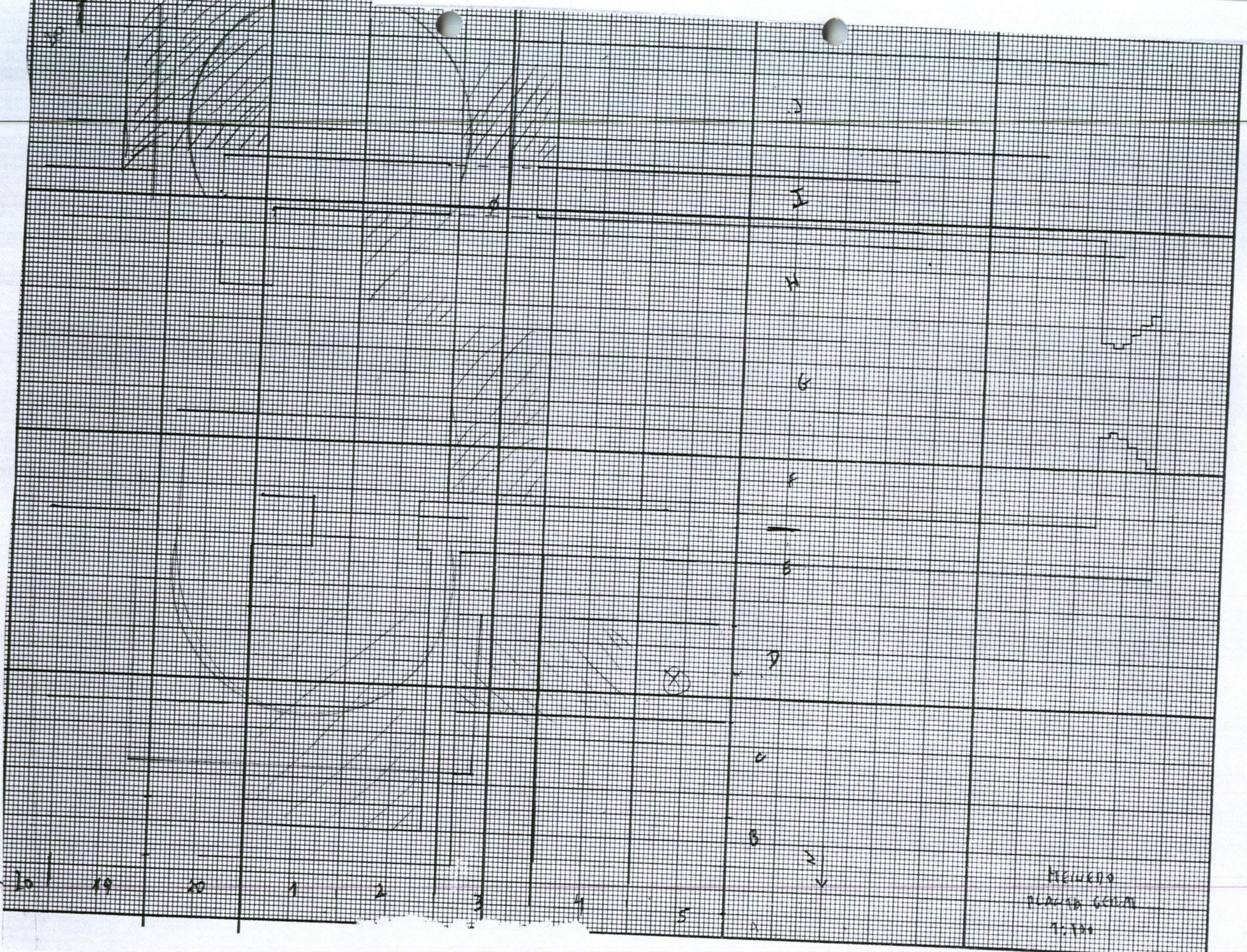

20 | 19 | 20 | 1 | 2 | 3 | 4 | 5

MEINER  
PLANO 3  
7:100

PLANO N=3

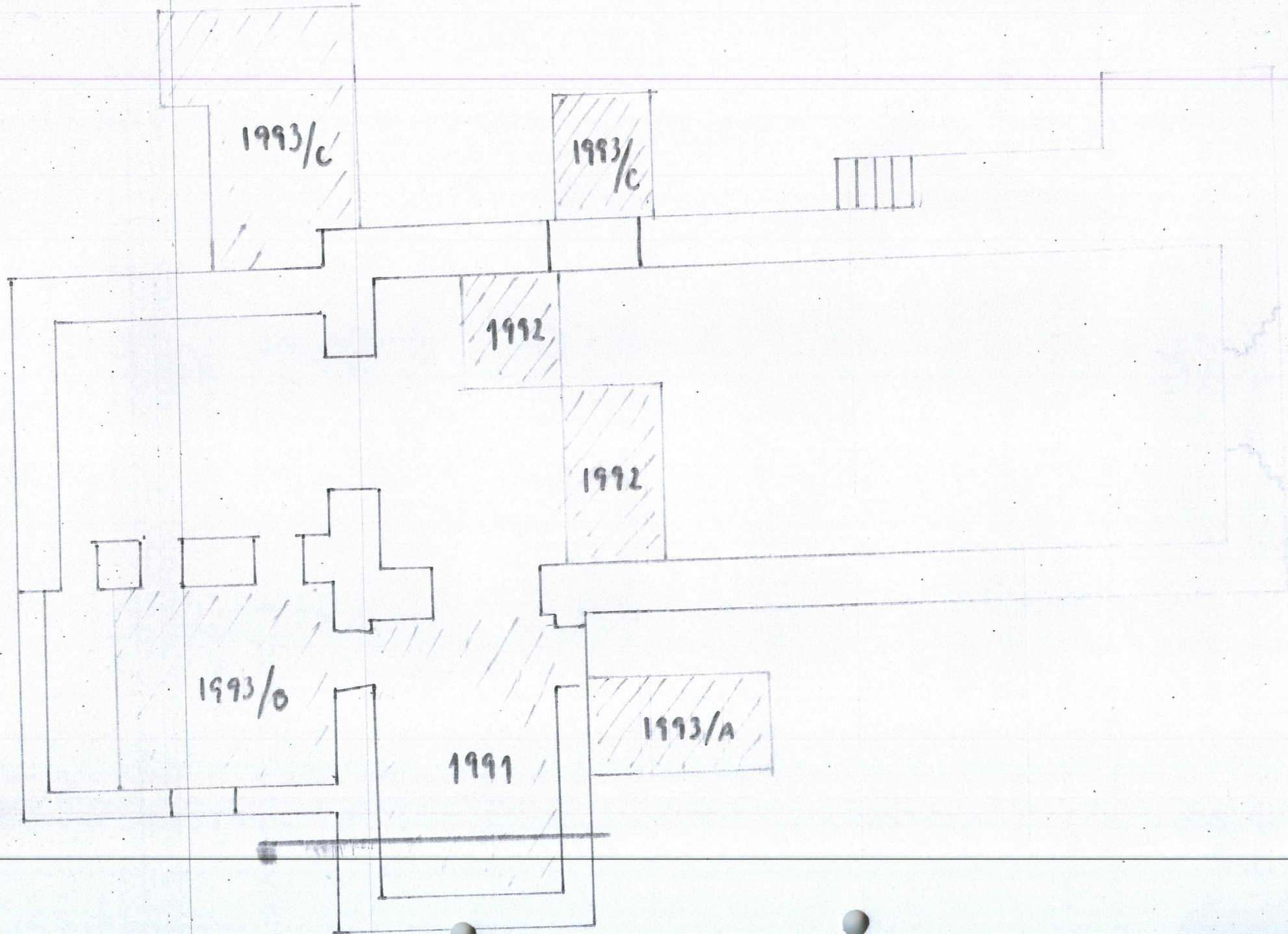

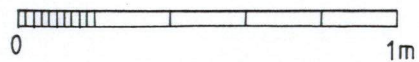
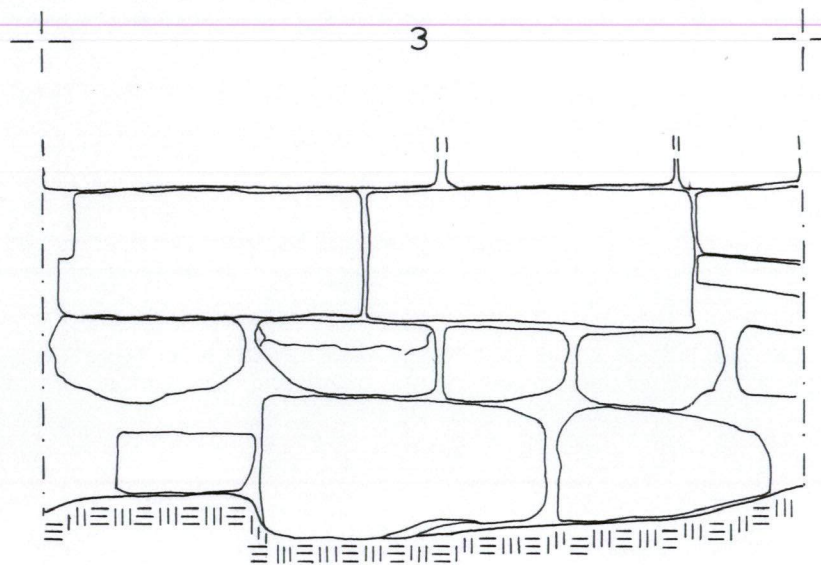

NAVE

Arq.		IPPAR	Arquivo nº
Des.	Sauvage P. Zappalà	Direcção Regional do Porto	Desenho nº 3
Q. F3		MEINEDO/92	Data 23.11.92
Esc: 1/20		Parede Sul da Igreja	Alçado

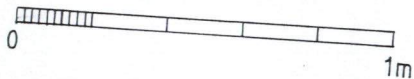
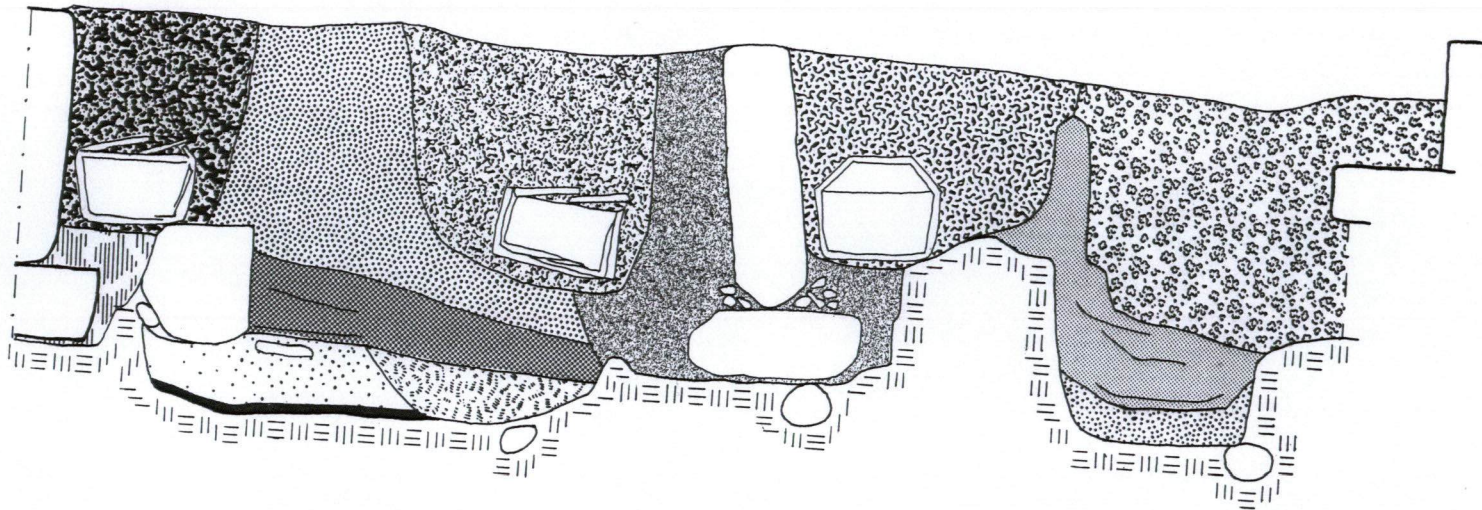

NAVE DA IGREJA

Arq.		IPPAR	Arquivo nº
Des.	Sauzeiro Carreira	Direcção Regional do Porto	Desenho nº 4
Q.F3, Q.G3		MEINEDO / 92	Data 2.12.92
Esc: 1/20			Corte Oeste

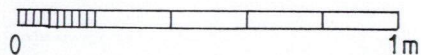
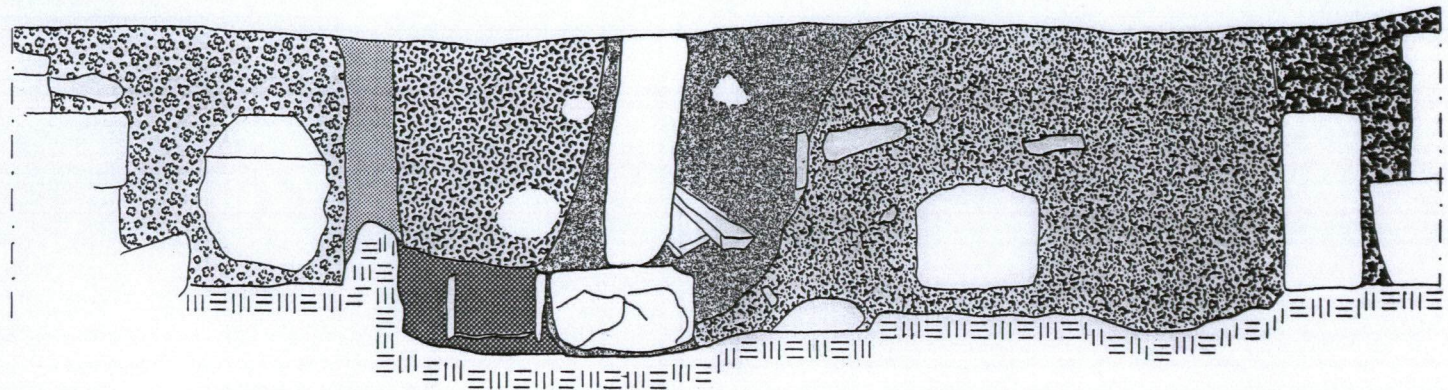

N.º 5

Arq.		IPPAR	Arquivo n.º
Des.	João de Castro	Direcção Regional do Porto	Desenho n.º 5
Q. F3, Q. G3		MEINEDO / 92	Data 23.11.92
Esc: 1/20			Corte Este

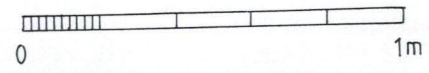
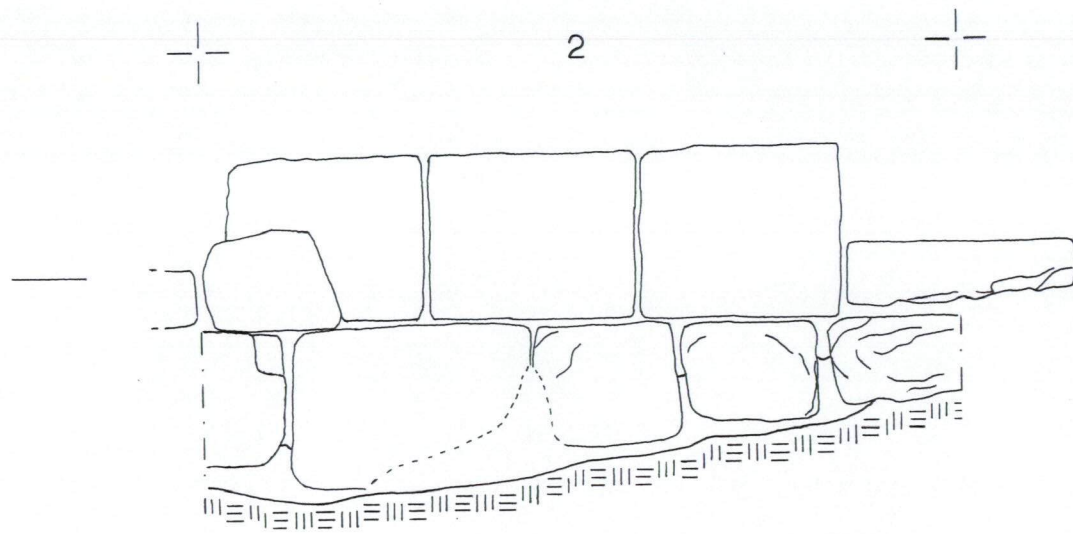

NAVE

Arq.		IPP A R	Arquivo nº
Des.	Sau de de P. P. P.	Direcção Regional do Porto	Desenho nº 6
Q. I 2		MEINEDO/ 92	Data 4. 12. 92
Esc. 1/20		Parede Sul da Igreja	Alçado



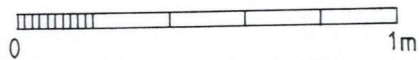
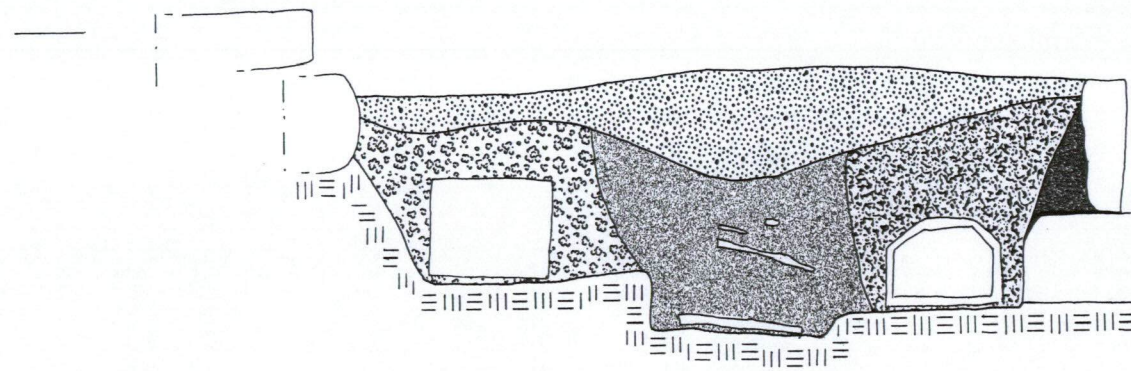

NAVE

Arq.		IPPAR	Arquivo nº
Des.	João de Deus Carvalho	Direcção Regional do Porto	Desenho nº 8
Q.	H2	MEINEDO / 92	Data 4.12.92
Esc:	1/20		Corte Oeste





4



3

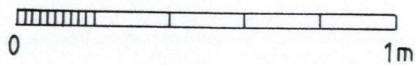
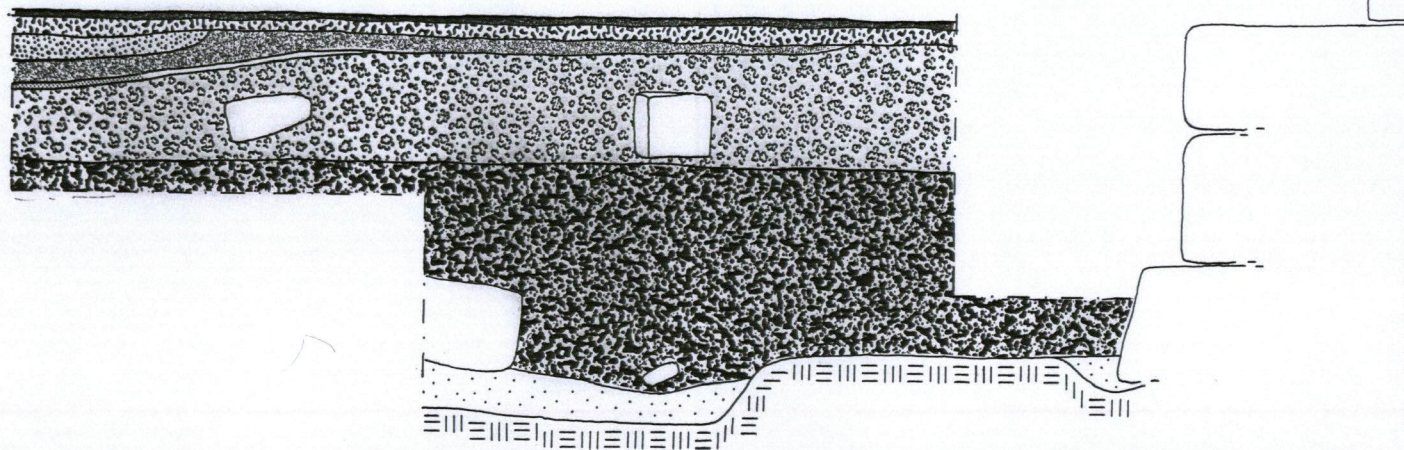

EXTERIOR NORTE

Arq.		IPPAR	Arquivo n.º
Des.	Sauzet de COSTA	Direcção Regional do Porto	Desenho n.º 10
Q. D 3, D 4			Data 3.03.93
Esc. 1/20		MEINEDO / 93	Corte Norte 10

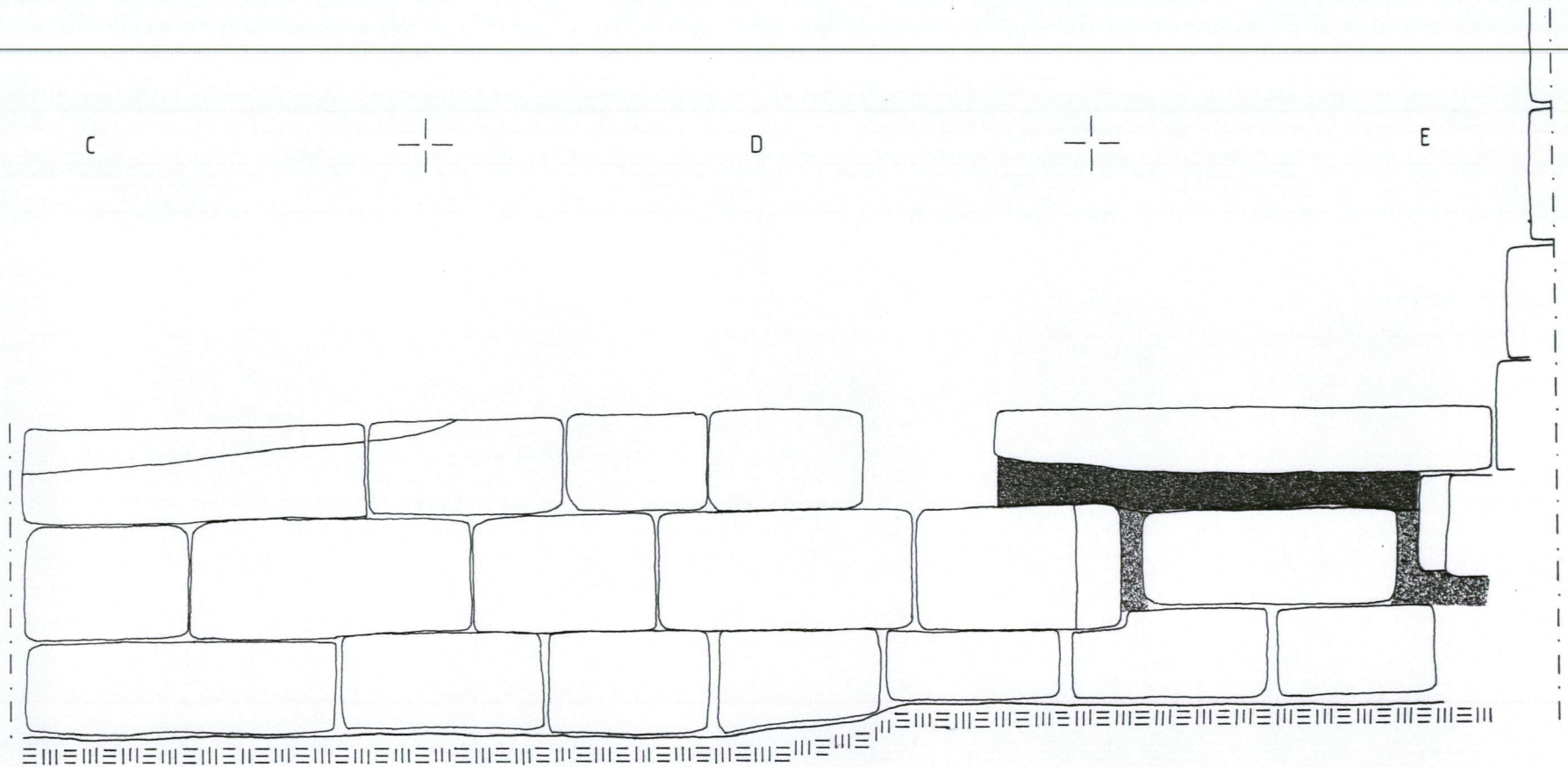

EXTENSION NORTE

Arq.	IPPAR	Arquivo n°
Des. <i>Souza da Correia</i>	Direcção Regional do Porto	Desenho n° 11
Q.C/D/E 3	MEINEDO / 93	Data 23.03.93
Esc: 1/20	Parede do Edifício Pré-românico	Alçado Oeste

20 19

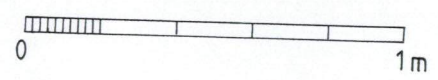
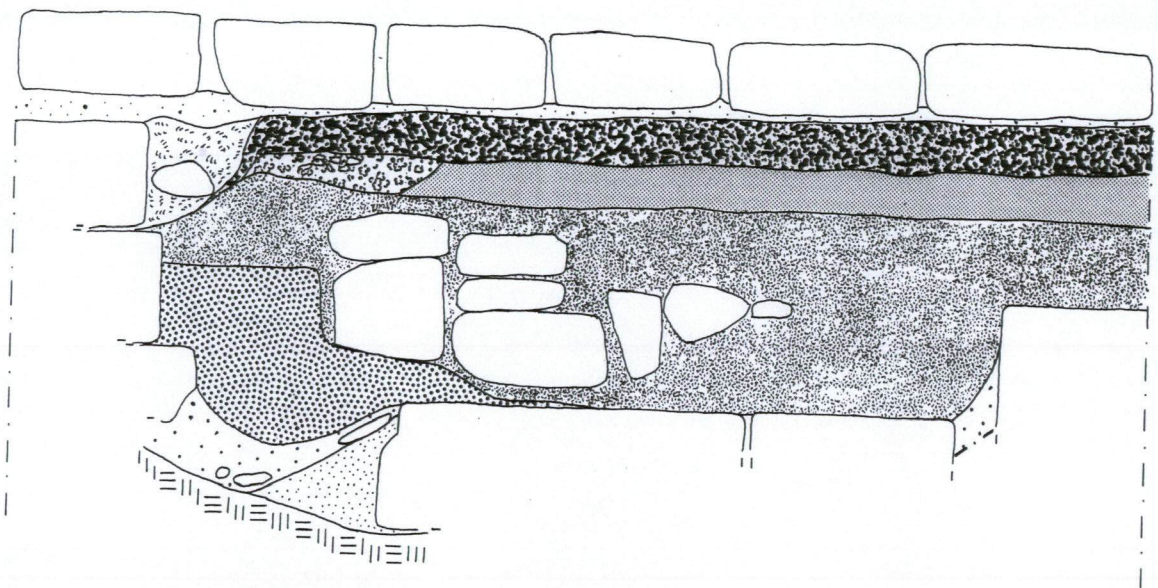

SACRISTIA

Arq.		IPPAR	Arquivo n.º
Des.	Sauvage Cresc.	Direcção Regional do Porto	Desenho n.º 12
Q. E	20/19		Data 11.03.93
Esc:	1/20	MEINEDO/93	Corte Norte



E

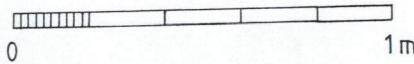
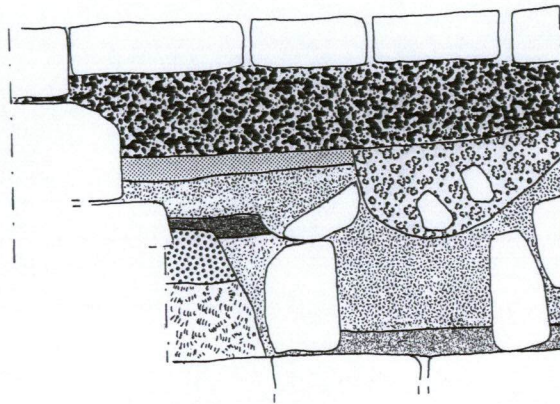

SACRISTIA

Arq.		IPPAR	Arquivo n°
Des.	Sauzet de Carpesin	Direcção Regional do Porto	Desenho n° 13
Q. E 19		MEINEDO / 93	Data 10.3.93
Esc 1/20			Corte Oeste

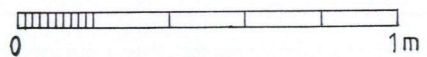
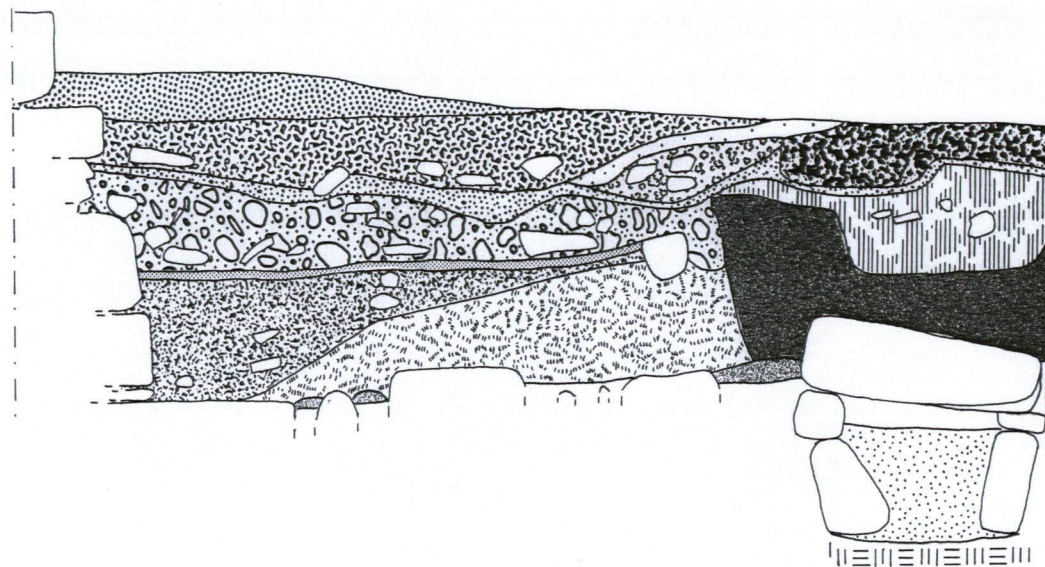

JACINTIA

ARQ		IPPAR	Arquivo n.º
DES.	Sandra de Carreira	Direcção Regional do Porto	Desenho n.º 14
Q. D/C	19		
Esc:	1 / 20	MEINEDO / 93	Corte Este

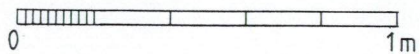
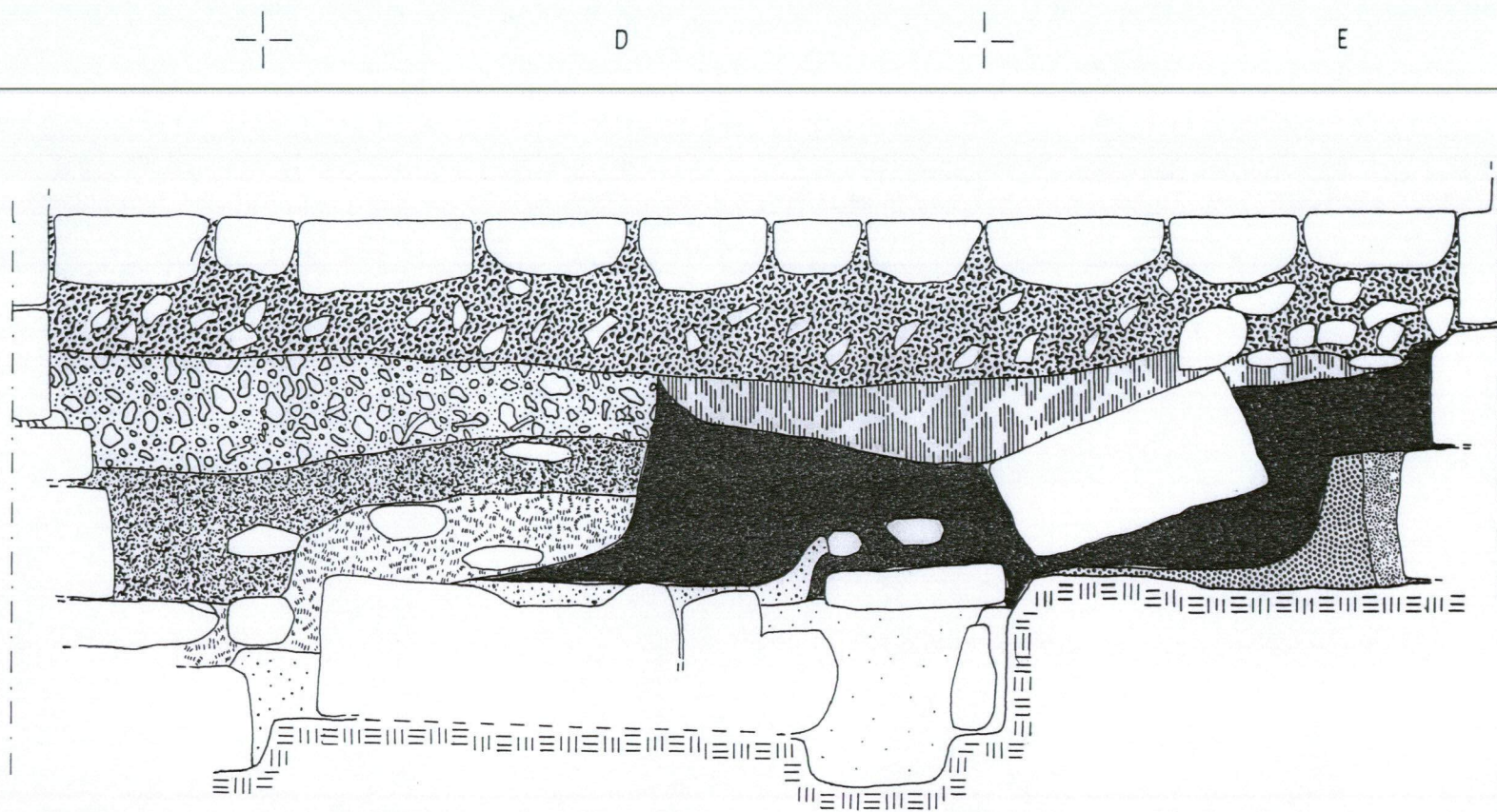

SACRISTIA

Arq.		IPPAR	Arquivo n°
Des.	Sauze de Correia	Direcção Regional do Porto	Desenho n° 16
Q. C/D/E	19		
Esc:	1/20	MEINEDO/93	Corte Este