

Panóias
17.14.27

COTA 824
C.S. 456581
Panóias

41.4323

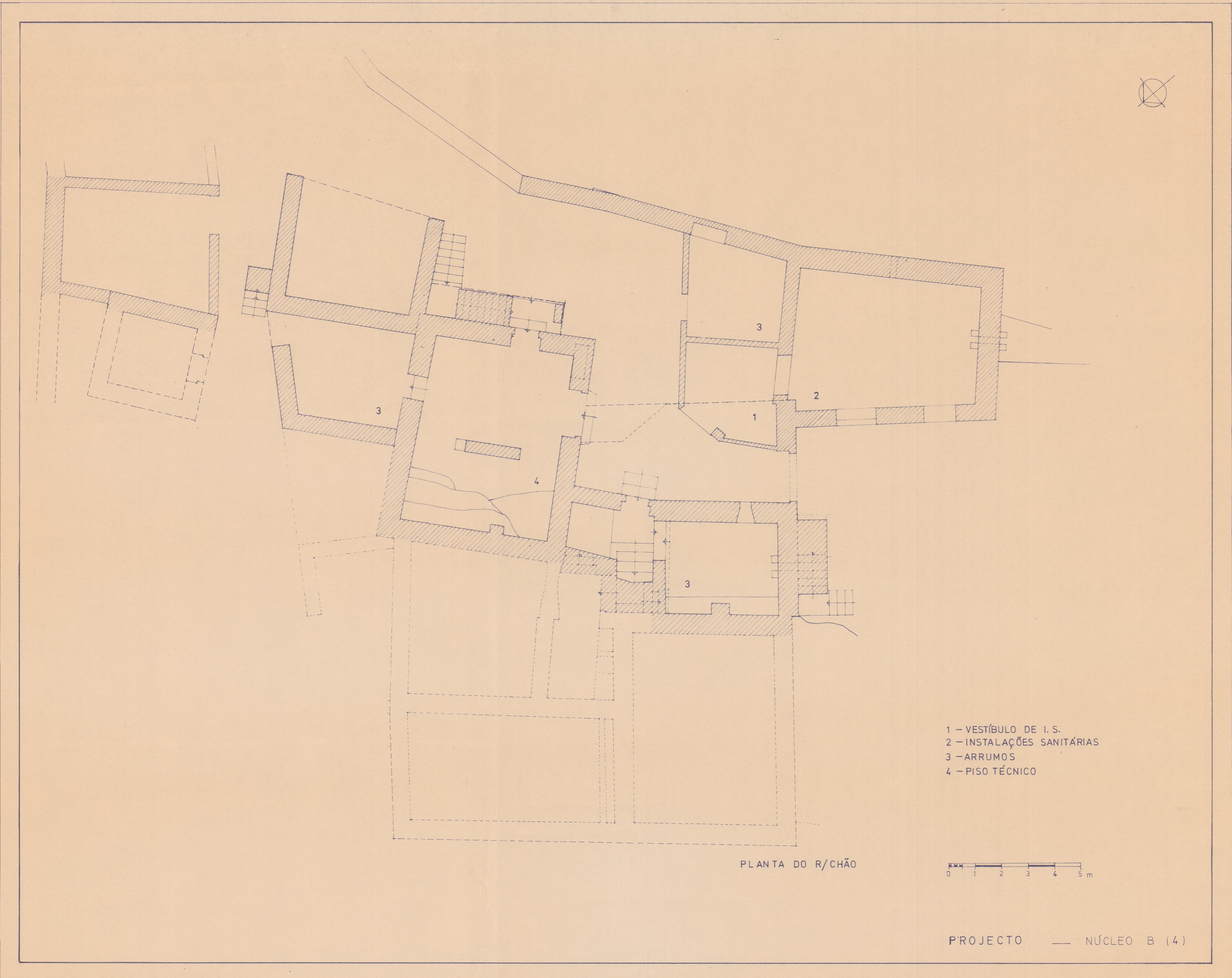

- 1 - VESTÍBULO DE I. S.
- 2 - INSTALAÇÕES SANITÁRIAS
- 3 - ARRUMOS
- 4 - PISO TÉCNICO

PLANTA DO R/CHÃO

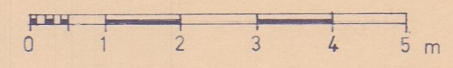

PROJECTO — NÚCLEO B (4)