

SONDAGEM N: 31

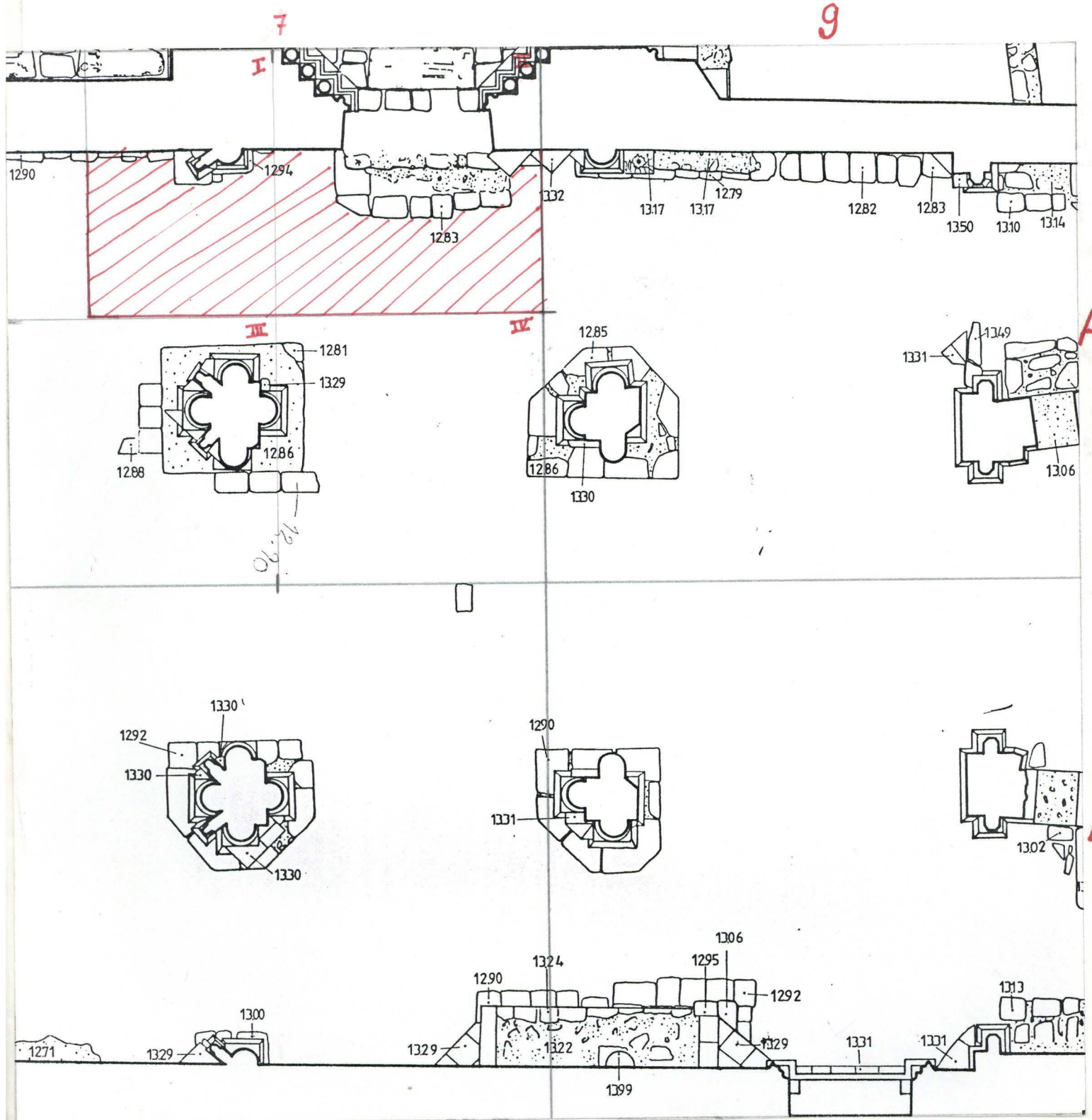

351,9 g — 316,7416 742°
 4,08 ~ — 0.6852 88824 = 2.79
 4,08 ~ — 0.128271396 = 2.97



1° Som.
 2° Cos.
 SONDAGEM N=31

382,5 g — 344,2844284°
 301 ~ — 0.270862072 = 0.81
 301 ~ — 0.962618168 = 2.89



0g —
 4,55 ~ — 0 = 0°
 4,55 ~ — 1 = 4.55



378,9 g — 341,0441044°
 2,40 ~ — 0.3248402229 = 0.77
 2,40 ~ — 0.945768907 = 2.26



2g — 1,800180018°
 4,17 ~ × 0.031413899 = 0.13
 4,17 ~ × 0.999506461 = 4.16



343,2 g — 308,9108911°
 3,65 ~ — 0.778123767 = 2.84
 3,65 ~ — 0.628110977 = 2.29



12,4 g — 11,16111611°
 4,55 ~ — 0.193568579 = 0.88
 4,55 ~ — 0.981086747 = 4.46



24,75g — 22,2722272°
 × 0.379088403 =
 × 0.92536046 =

32,69 — 29.34293429°
 175 ~ — 0.490035794 = 0.85
 175 ~ — 0.871702311 = 1.52



$$313,5g - 282,1782178^\circ$$

$$7,77u - 0.977496163 = 7.59$$

$$7,77u - 0.210953195 = 1.63$$

$$321,5g - 289,3789379^\circ$$

$$8,06u - 0.94334697 = 7.60$$

$$8,06u - 0.331814378 = 2.67$$

$$334,4g - 300.990099^\circ$$

$$8,85u - 0.857256289 = 7.58$$

$$8,85u - 0.514889944 = 4.55$$

$$337,2g - 303.510351^\circ$$

$$7,25u - 0.833786096 = 6.04$$

$$7,25u - 0.552087625 = 4.00$$

$$341g - 306,9306931^\circ$$

$$6,96u - 0.799362901 = 5.56$$

$$6,96u - 0.600848526 = 4.18$$

$$347,9g - 313,1413141^\circ$$

$$5,99u - 0.7296694 = 4.37$$

$$5,99u - 0.683800092 = 4.09$$

$$356g - 320,4320432^\circ$$

$$4,74u - 0.636992973 = 3.03$$

$$4,74u - 0.770869607 = 3.65$$

$$363g - 326,7326733^\circ$$

$$5,07u - 0.548546104 = 2.78$$

$$5,07u - 0.836120309 = 4.23$$

$$365,2g - 328,7128713^\circ$$

$$5,42u - 0.519327147 = 2.81$$

$$5,42u - 0.854575516 = 4.63$$

$$383g - 344,7344734^\circ$$

$$3,30u - 0.263292652 = 0.86$$

$$3,30u - 0.964716009 = 3.18$$

$$5,5g - 4,95049505^\circ$$

$$3,37u - 0.086294973 = 0.29$$

$$3,37u - 0.99626963 = 3.35$$

$$379,8g - 359,8559856^\circ$$

$$4,52u - 2.513522804 = 0.01$$

$$4,52u - 0.999996841 = 4.51$$

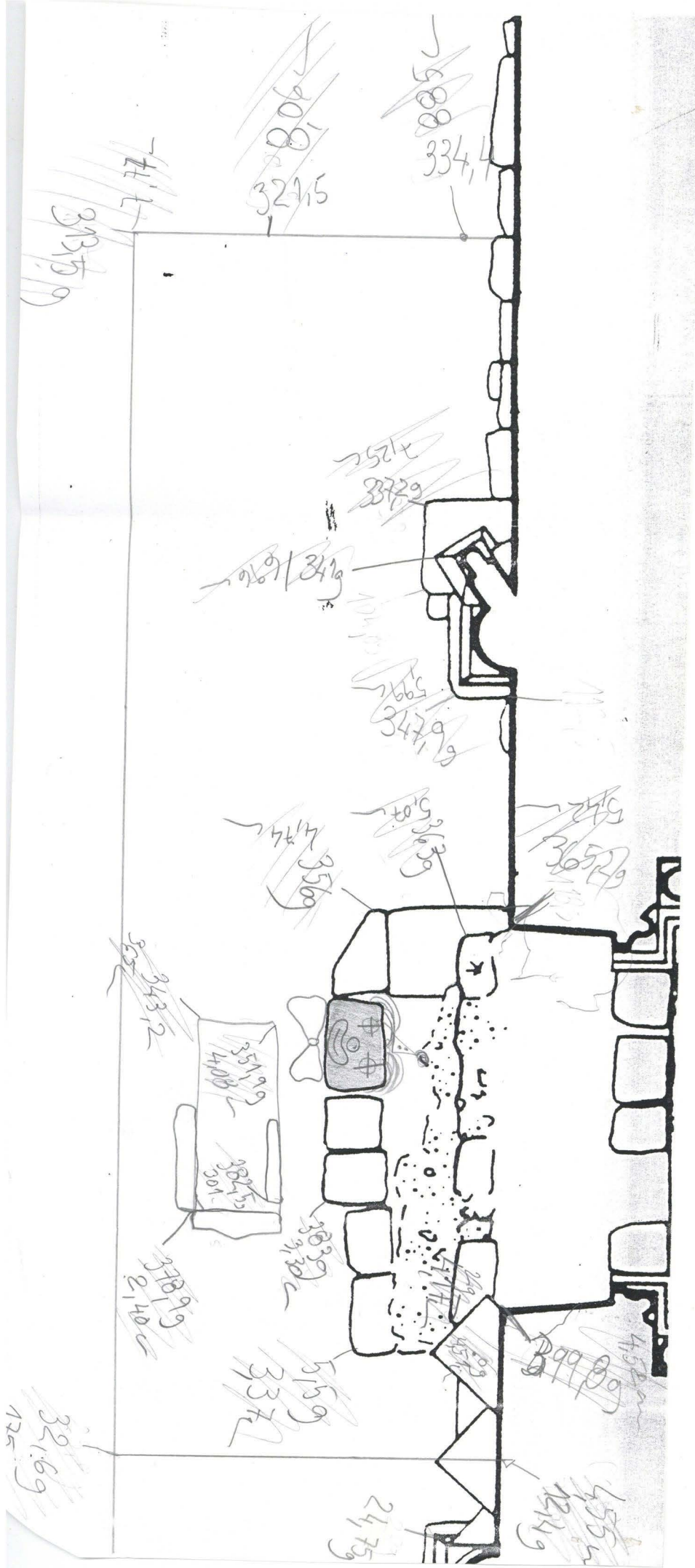

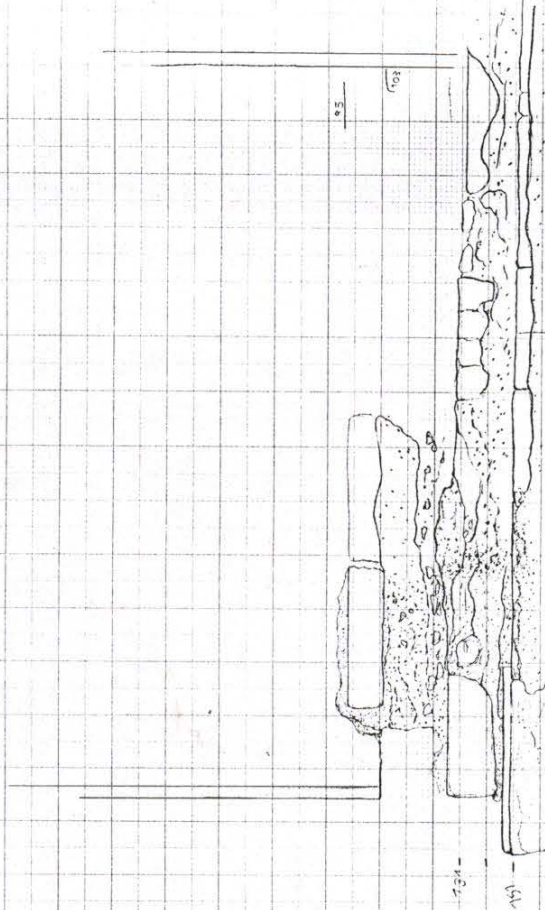

4210769

à 13^a fada de fuma

S. C. V. 93
 "Faria Nova"
 11.0.1/22-1 N
 A.F.R. E. II

6

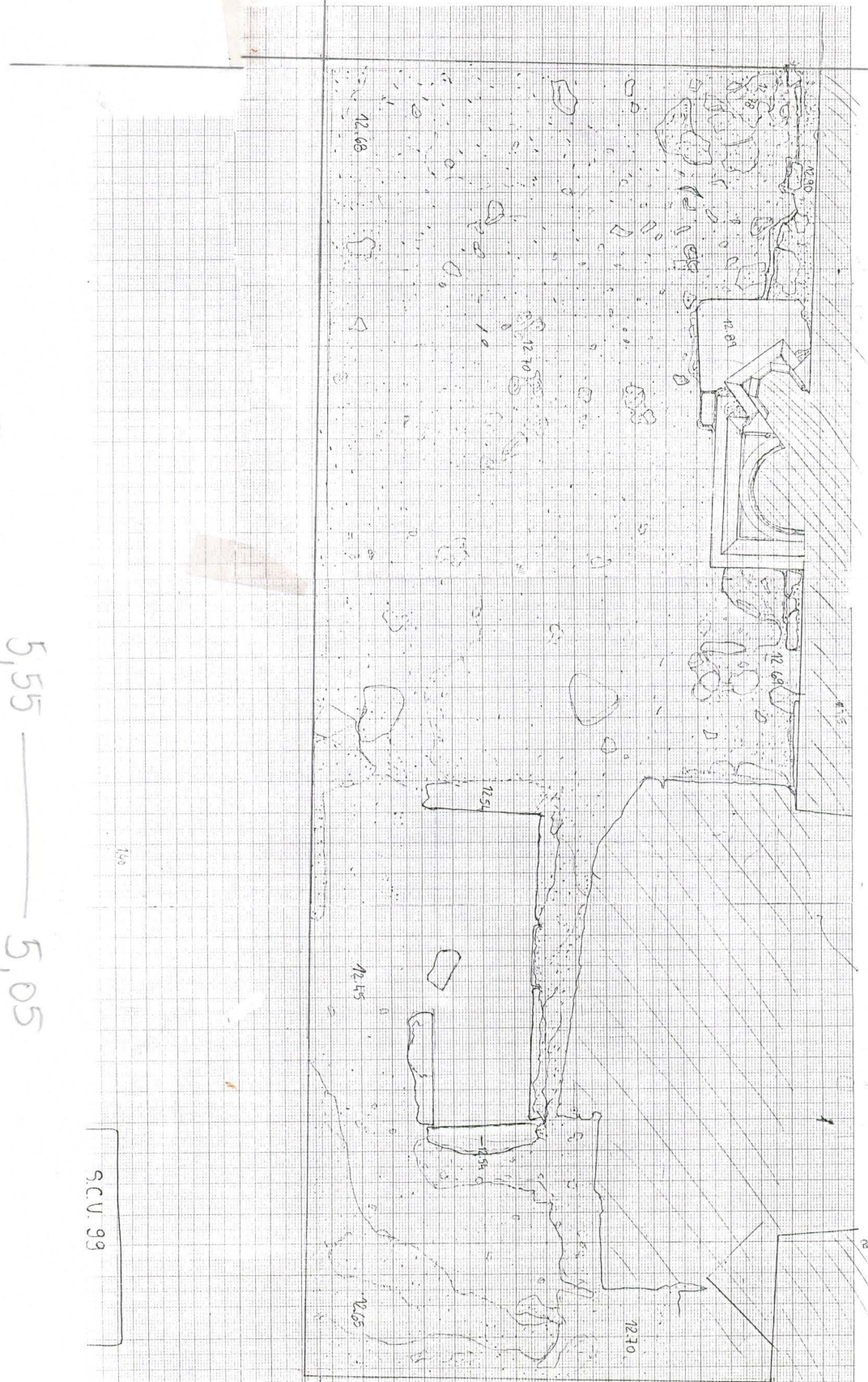
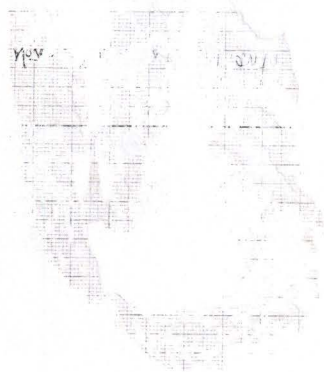

5,55 ————— 5,05
 5,60 ————— 6
 5,09

9 C.V. 93

2

2

N
12.1/20

S.C.V. 99
Sond. N=31
Planta N=1

13 de Fevereiro de 1999

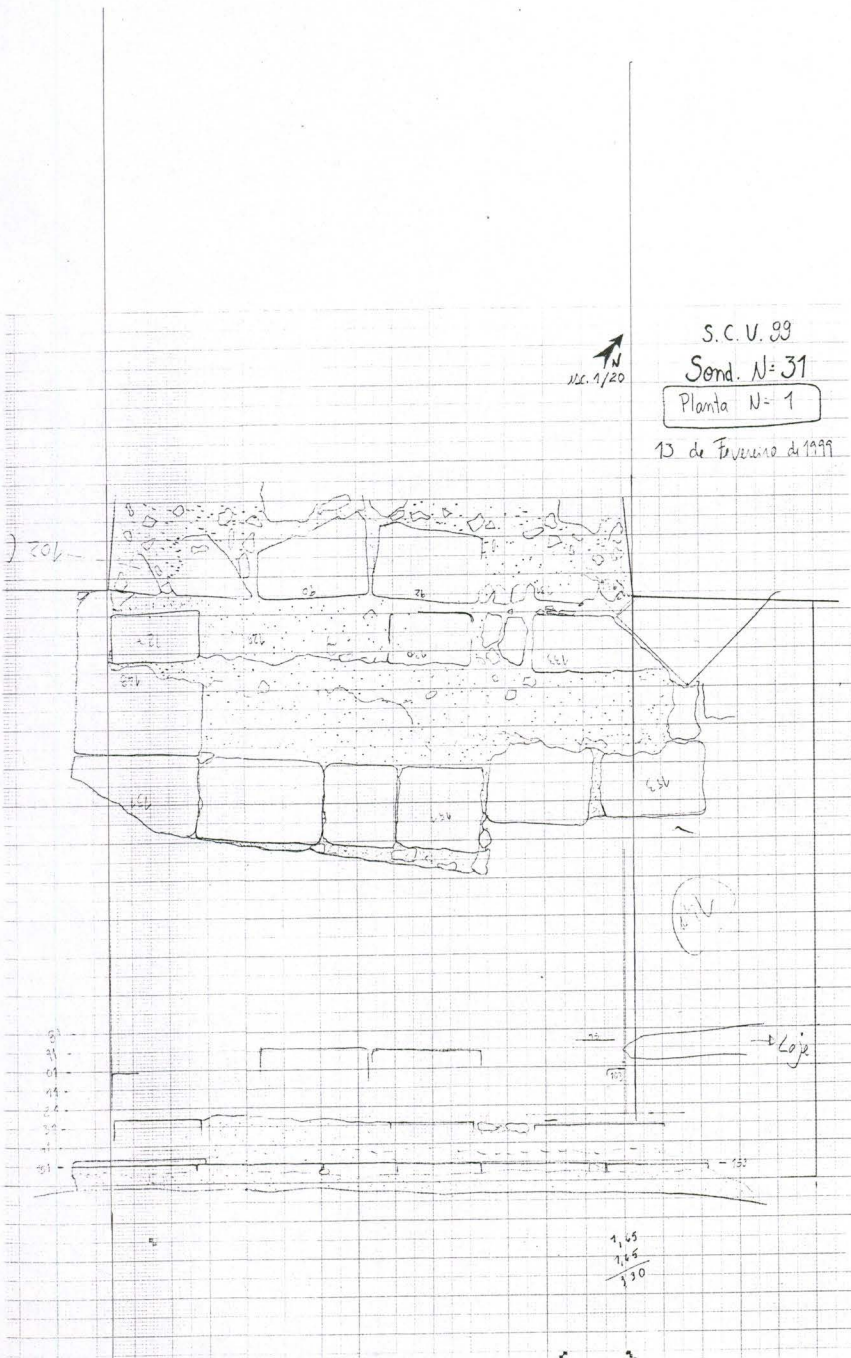

1.65
1.65
1.30

22

~~231.000~~
~~46.200~~

~~184.800~~
12

~~369.600~~
~~184.800~~

~~2.217.600~~

~~224 074~~
~~39.270~~

~~04.804~~

~~3000.000~~
~~2.217.600~~

~~782.400~~ 12
062 65.2
024
0000.

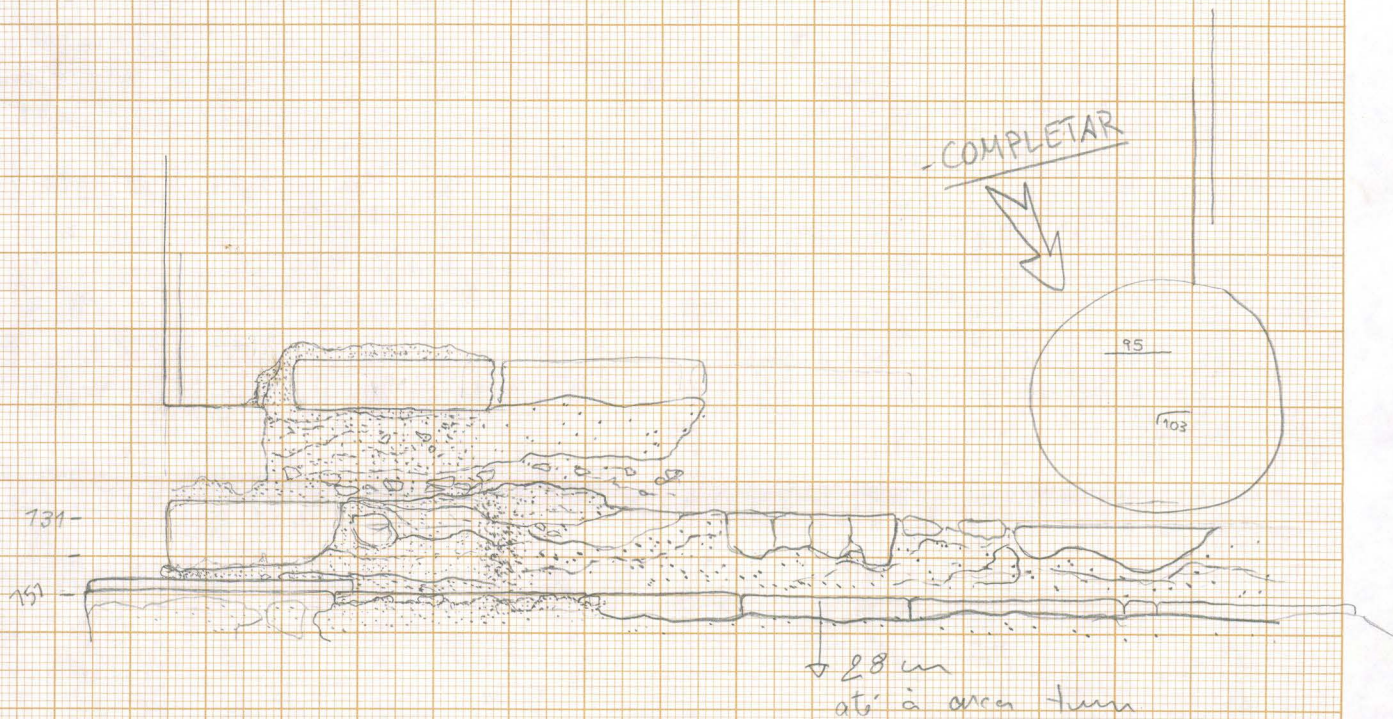

à 13^a fiada de pida

S. C. V. 99
 " Porta Norte "
 ux. 1/20 ↗
 A7 Q. I. II DES: Mónica Guedes

S.C.U. 99

Sond. N° 31

Planta N° 1

13 de Febrero de 1999

DES: Mónica Giménez

10.1/20

14.34

