

M7.1 - planta 1/20

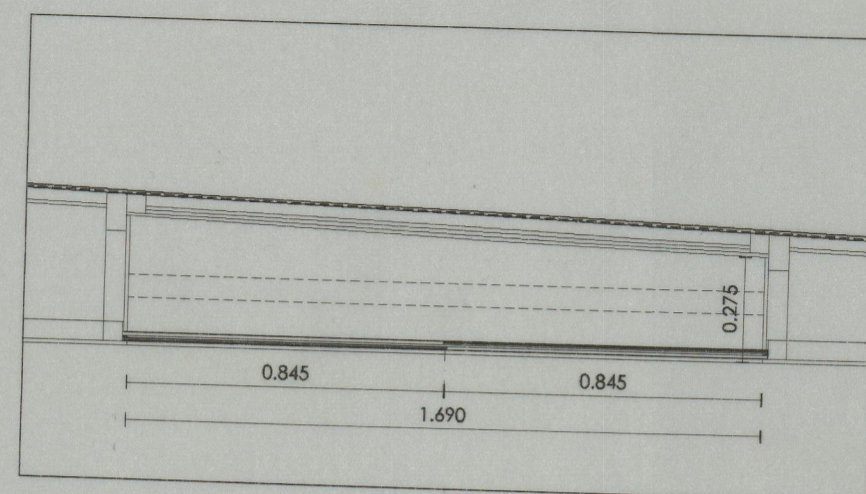

M7.2 - planta 1/20

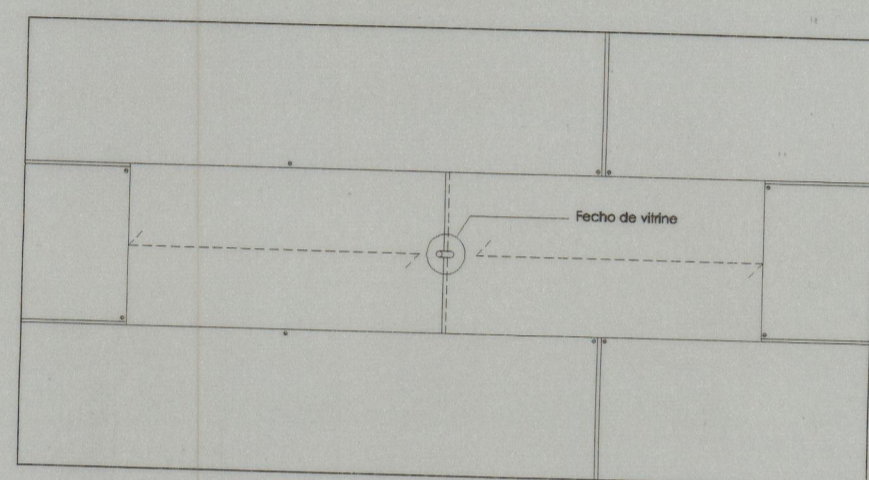

M7.2 - alçado 1/20

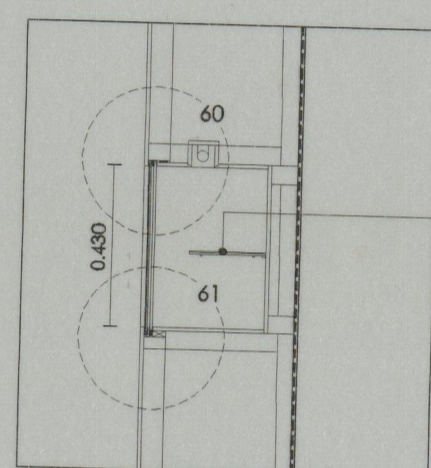

M7 - corte 1/20

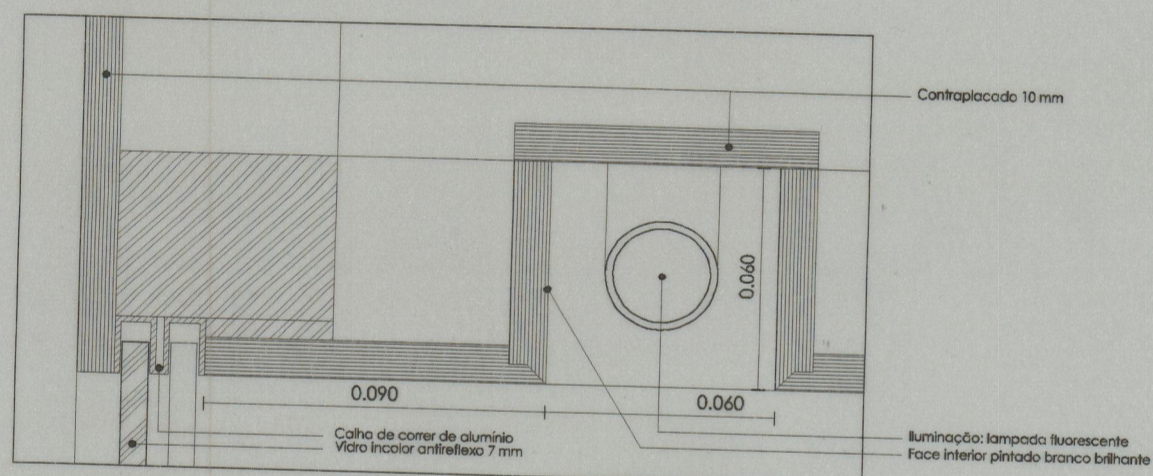

M7 - Pom. 60 - 1/2

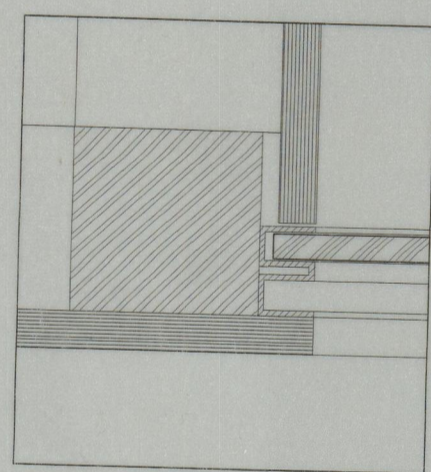

M7 - Pom. 58 - 1/2

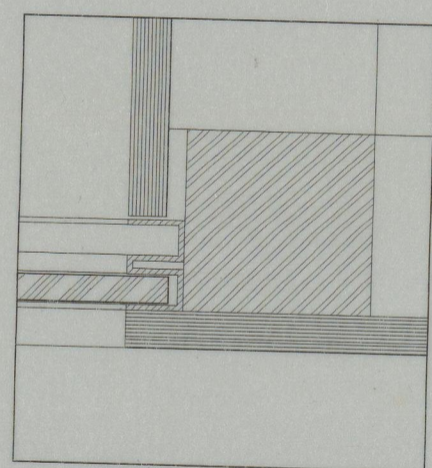

M7 - Pom. 59 - 1/2

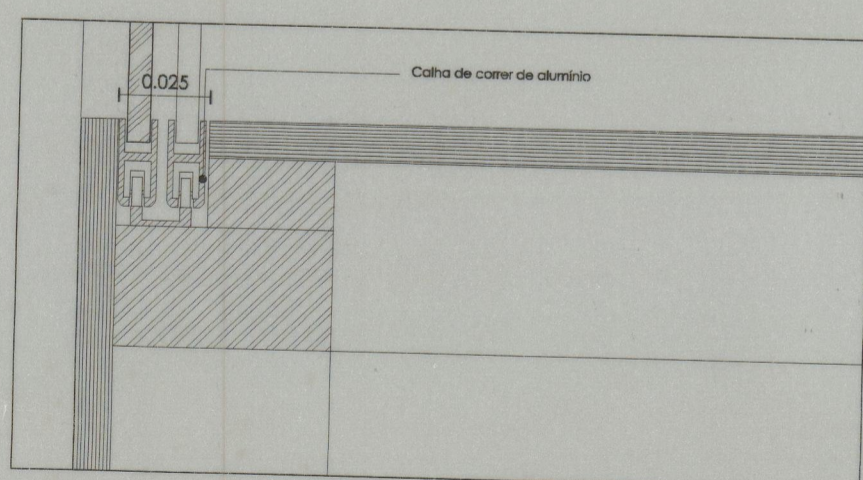

M7 - Pom. 61 - 1/2

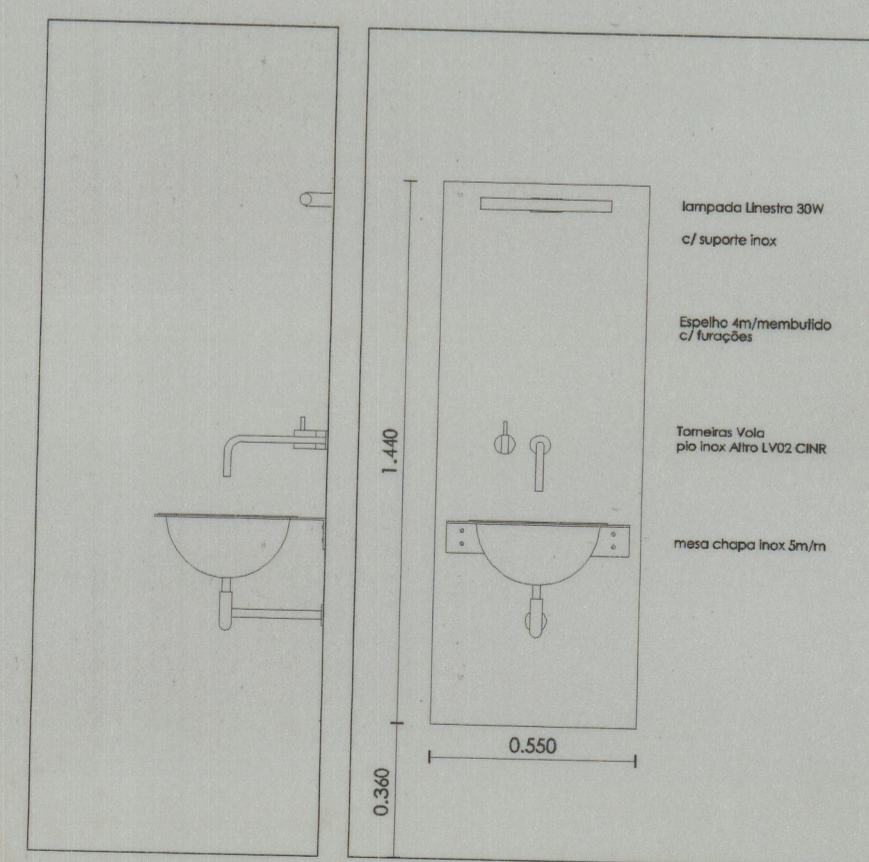

Edifício principal - casa/banho - peças e armaduras 1/20

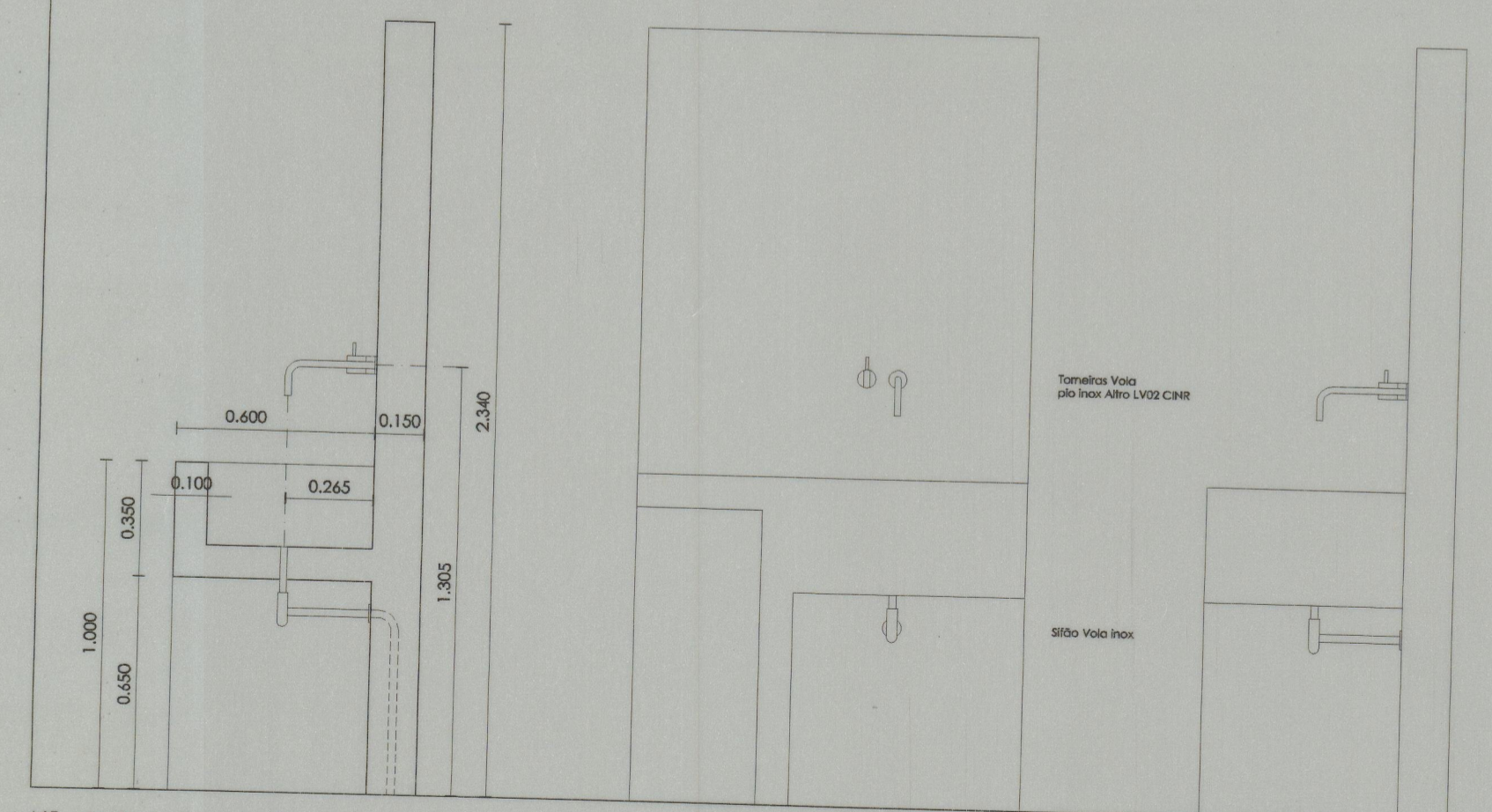
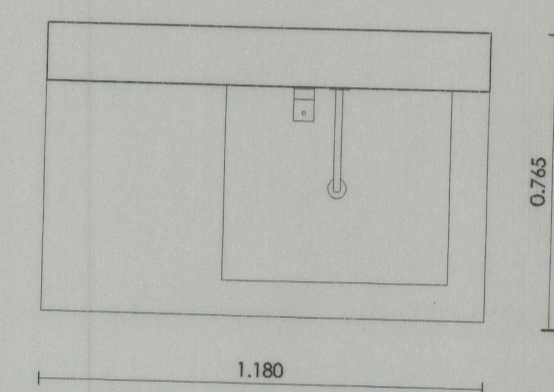
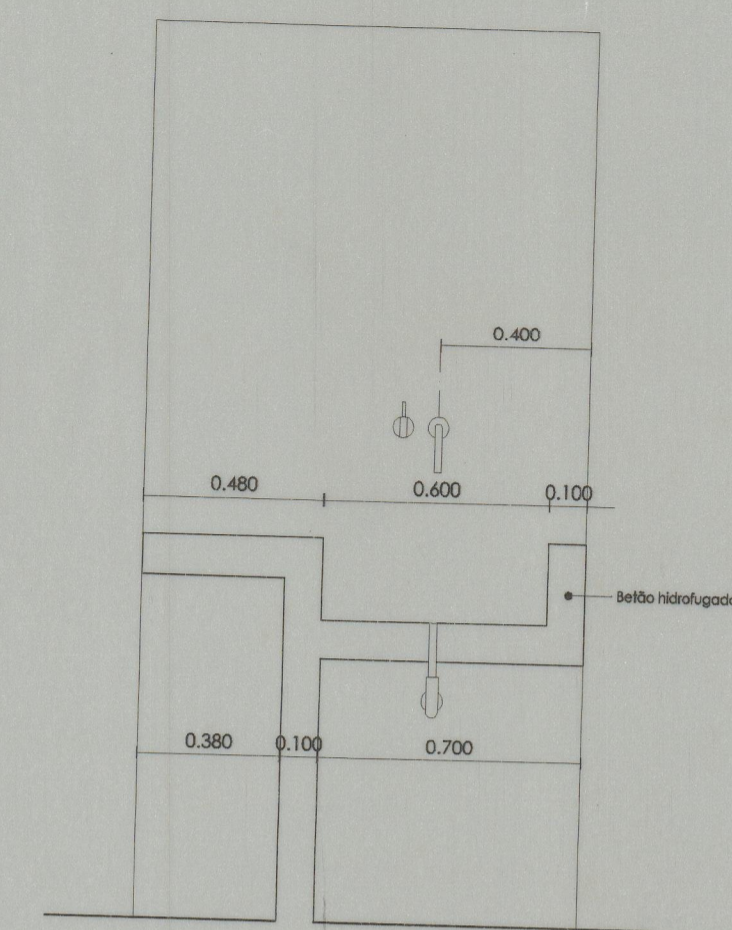

M5 - planta, cortes e alçados - 1/20

RESERVADOS TODOS OS DIREITOS DE ALGOR NADA TEREMOS DO SR. VIRGÍNIO MOUTINHO

IPPAR  
 ESTAÇÃO ARQUEOLÓGICA DE SENDIM - PROJECTO DE EXECUÇÃO  
 PORMENORES DE MÓVEIS M5, M7, E EDIFÍCIO PRINCIPAL / CASA DE BANHO  
 VIRGÍNIO MOUTINHO ARQUITECTO, LDA

REPRODUCIBILIDADE  
 ESC. 1/20 1/2  
 ADR 1999

41-3855  
 Cota 2964